

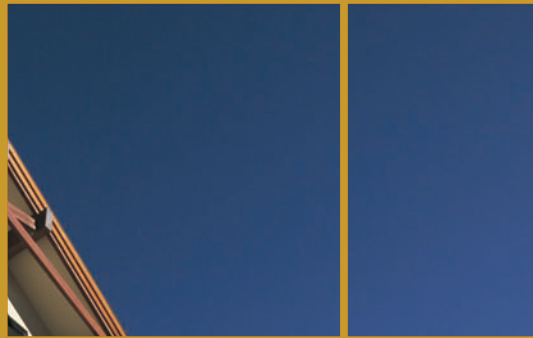

# Nurender<sup>TM</sup>







## Cladding Solution



Cladding Solutions  
Specification Manual



## NU-RENDER TABLE OF CONTENTS

	<b>1. Scope and Limitations of Nu-Render</b>	<b>2</b>
	<b>2. Nu-Render Building Regulations</b>	<b>3</b>
	 <b>3. Nu-Render Design and Construction Information</b>	<b>3</b>
	<b>4. Nu-Render uPVC Component Range</b>	<b>4</b>
	<b>5. Nu-Render System Specifications</b>	<b>5</b>
	<b>6. Installation Instructions</b>	<b>7</b>
	<b>7. Areas where additional care is required</b>	<b>12</b>

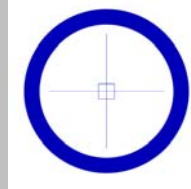

### Details

<b>01 – Base Detail</b>	<b>13</b>
<b>02 – Window Head Detail</b>	<b>14</b>
<b>03 – Window Jamb Detail</b>	<b>15</b>
<b>04 – Window Sill Detail</b>	<b>16</b>
<b>05 - Control Joint</b>	<b>17</b>

**Product Specification Sheets** 16

**Warranty Terms** 20

**Preventative Maintenance Schedule** 22



## **1. SCOPE AND LIMITATIONS OF NU-RENDER**

### **1.1. Scope**

Nu-Render is a Proprietary Plaster Coating System for use within the following scope:

- With Substrate of concrete masonry or in-situ or pre-cast concrete up to 3 storeys, with a maximum height from ground to eaves of 10m; and
  - with substrates of clay or concrete brick veneer designed and constructed in accordance with the scope of NZS 3604; and
  - with floor plan area limited only by seismic and structural control joints; and
  - with supporting structures designed and constructed in accordance with NZBC; and
  - detached and located 1m or more from the relevant boundary.
- With AAC veneer in conjunction with the manufacturers specification and technical literature; and
  - On residential and light commercial timber frame buildings within the scope limitations set out in NZS 3604 in regard to building height, number of storeys, shape and size; and
  - On buildings situated in NZS 3604 Building Wind Zones up to, and including 'Very High'; and
  - With aluminium window and door joinery; and
  - With installation carried out only by Watty! Granosite / Nu-Age Trained applicators.
- With AAC Block or EPS Block when designed and constructed in conjunction with the manufacturers specifications and associated Technical Literature.

### **1.2 Site and Structural Requirements**

Foundation design to comply with requirements of NZS 3604:1999 or be designed and approved by Structural Engineer.

Timber framed buildings to be coated with Nu-Render are to be designed in accordance with NZS 3604:1999 or be designed and approved by a structural engineer.

### **1.3 Bracing**

All bracing for structures must comply and be installed in accordance with the substrate manufacturers specifications.

### **1.4 Wind Loading**

Nu-Render is suitable for use in wind zones up to and including Very High (VH) as defined in NZS 3604:1999 in terms of performance relating to external moisture and structure.

## **2. NU-RENDER BUILDING REGULATIONS**

Nu-Render if used, designed, installed and maintained in accordance with the statements and specifications provided in this manual, will meet, or contribute to meeting the following provisions of the NZBC: (Dependant on substrate Nu-Render applied to)

### **Clause B1 Structure**

Performance B1.3.1, B1.3.2 and B.1.3.4 for the relevant physical conditions of B1.3.3.

### **Clause B2 Durability**

Performance B2.3.1 (b), 15 Years and B2.3.1 (c), 5 years Nu-Render meets these requirements.

### **Clause E2 External Moisture**

Performance E2.3.2 Nu-Render meets this requirement.

### **Clause F2 Hazardous Building Materials**

Performance F2.3.1 Nu-Render meets these requirements and will not present a health hazard to people.

## **3. NU-RENDER DESIGN INFORMATION**

Nu-Render will provide a seamless monolithic finish to the exterior of a building provided sensible design methods are followed.

### **3.1 Substrate Variations and Tolerances**

The substrate material must be plumb and true, minor variations of up to 3mm can be masked by the plaster system, major variations, over 3mm will be reflected in the plaster system.

If major variations in substrate are evident Watty Granosite / Nu-Age Plaster has various systems which can minimise variations. Contact you local Watty Granosite Representative for information on alternative systems.

### **3.2 Large wall areas**

Avoid large expanses of unbroken exterior wall. Windows, doors and feature components can be incorporated to hide imperfections, which will create a better finish.

### **3.3 Large Eaves and projecting trim**

The addition of eaves dramatically reduces the effects on buildings elements from sun, wind and rain which can contribute to damage of the exterior cladding. Protection of openings and intersections is recommended by Watty Granosite to extend the lifespan of the cladding and to reduce the maintenance requirements of the cladding at these points.

## 4. NU-RENDER uPVC COMPONENT RANGE

### Nu-Render Jamb

This component clips in behind the aluminium joinery and returns over the substrate with 'lugs' provided for the plaster to adhere.

### Nu-Render Sill

This component clips in behind the aluminium joinery and returns over the substrate with 'lugs' provided for the plaster to adhere.

### Render Stop

This 7mm component is installed at locations where the plaster coating system must terminate. The uPVC component is adhered to the substrate using a suitable BRANZ Appraised Construction Adhesive and utilises punchings and glass fibre mesh in the heel of the component, allowing the leveling coat to adhere to the substrate and the component locking it in place.

### Pre-Meshed Corner Bead

This component is installed at all external corner locations and the jambs of windows and doors to provide additional reinforcing and durability at these high risk impact points. The meshed corner bead is adhered to the substrate using an appropriate Construction Adhesive; the meshed corner bead is totally encapsulated in the Nu-Render Application once the Leveling coat has been applied.

### Nu-render Control Joint

These control joints are installed to allow controlled movement of the cladding by allowing the rubber centre section of the control joint to flex laterally reducing surface cracking of the plaster.

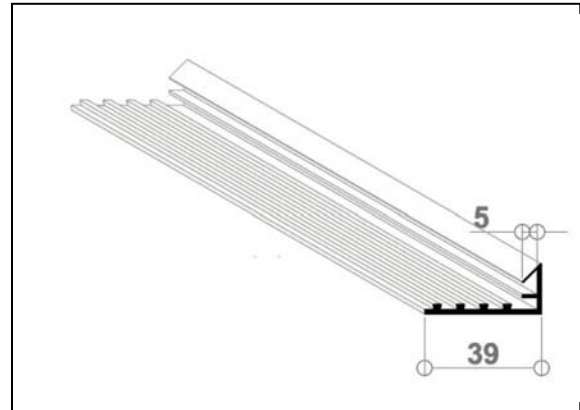

Nu-render Jamb Flashing

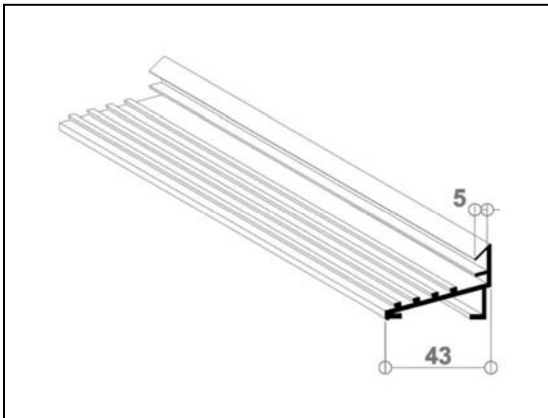

Nu-render Jamb Flashing

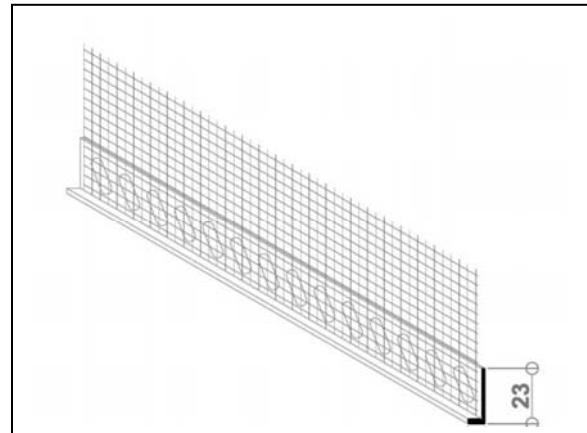

Nu-render - Render Stop

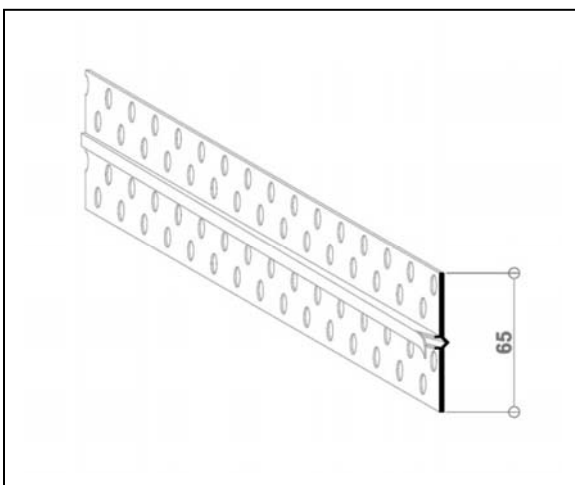

Nu-Render Control Joint

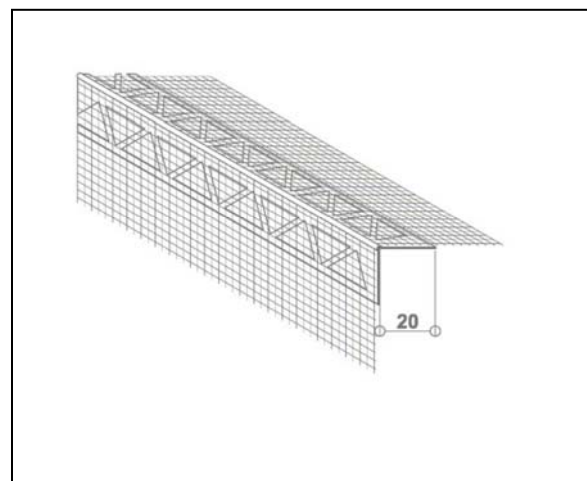

Pre-Mesh Corner Bead

## 5. NU-RENDER SYSTEM SPECIFICATIONS

### 5.1 Plasters

#### **Leveling Coat of Granosite / Nu-Age Thin Bed Render or Adhesive Mortar Coarse (dependant on Substrates – See Table Below)**

A Polymer modified Portland Cement-based plaster, comprising of coarse grade sands, adhesives and additional additives, supplied in 25kg bags. Granosite / Nu-Age Thin Bed Render or Adhesive Mortar Coarse can be trowel applied but for optimum results Wattyl Granosite / Nu-Age Plaster recommends pump application to a thickness of 3-5mm.

#### **Finishing Coat of Granosite / Nu-Age Fine, Medium, Coarse Cement Based Finishes**

Granosite / Nu-Age Finishes are sand, cement and lime based plaster, supplied in 25 kg bags. It is trowel or spray applied

#### **Finishing Coat of Granosite / Nu-Age Adobe Finish**

Granosite / Nu-Age Adobe Finish is sand, cement and lime based plaster, supplied in 25 kg bags.

It is trowel applied to give a sculptured finish 3-5 mm in thickness

#### **Finishing Coat of Acrylic Texture**

See Wattyl Granosite Paintworks Specification Manual.

### Levelling Coat / Intermediate Coat Requirements

Substrate	Base Product	Mesh Reinforcement
Masonry Block	Thin Bed Render or Adh. Mortar Coarse	Mesh Optional
AAC Block	Adh. Mortar Coarse Only	Mesh Required
In-situ or Pre-cast Concrete	Thin Bed Render or Adh. Mortar Coarse	Mesh Optional
Clay or Concrete Brick Veneer	Thin Bed Render or Adh. Mortar Coarse	Mesh Optional
AAC Panel Veneer	Adh. Mortar Coarse Only	Mesh Required
EPS Block	Adh. Mortar Coarse Only	Mesh Required

For alternative Substrates contact you local Wattyl Representative.

### 5.2 Flexible Sealant

A suitable BRANZ Appraised flexible sealant must be used to seal openings etc, as and where required as stated in the substrate manufacturer's specifications and Wattyl Granosite / Nu-Age Plaster Technical Manual.

### 5.3 Windows and Doors

The installation and flashing of windows, doors and all openings/penetrations in the substrate in which the Nu-Render Application is installed is the responsibility of the designer and/or the substrate manufacturer. Wattyl Granosite / Nu-Age Plaster supplies Flashing Components available for use around window and door openings. See Section 4 uPVC Flashing Components.

### 5.4 Proprietary Waterproofing Products

In some circumstances a Proprietary Waterproofing membrane must be applied to the substrate prior to the Nu-Render Plaster system application.

Before Purchasing and installing Proprietary Waterproofing Products ensure the product will be compatible for over coating with cement based plasters.

Wattyl Granosite / Nu-Age Plaster Supplies and Recommends a cement based Proprietary Waterproofing membrane which can be trowel applied prior to the Application of the Nu-Render Plaster System.

For further information contact your local Wattyl Representative.

**Wattyl Granosite / Nu-Age Plaster cannot be held liable for delamination, lack of bond and other associated issues of the Nu-Render plaster system when installed over All but the recommended Proprietary Waterproofing System.**

### 5.5 Weather Protective Paint Coating See Wattyl Granosite Paintworks Specification Manual.

Application must be carried out in accordance with the Wattyl Granosite specifications and instructions and must meet the performance requirements of the NZBC.

### 5.6 System Characteristics

The Nu-Render Cladding Solution has been designed to provide a monolithic coating to Clay Brick, Masonry, In-Situ and Precast Concrete, AAC substrates and EPS Block Substrates. The thickness of the Nu-render system does not allow for straightening of the substrate, tolerances in the substrate will be reflected in the finished system. For areas where substrate tolerances are great, use Wattyl Granosite / Nu-Age Nu-Solid Cladding Solution where applicable.

A Proprietary Waterproofing Membrane Product may need to be applied to block base prior to plaster system application - see substrate manufacturers specs.

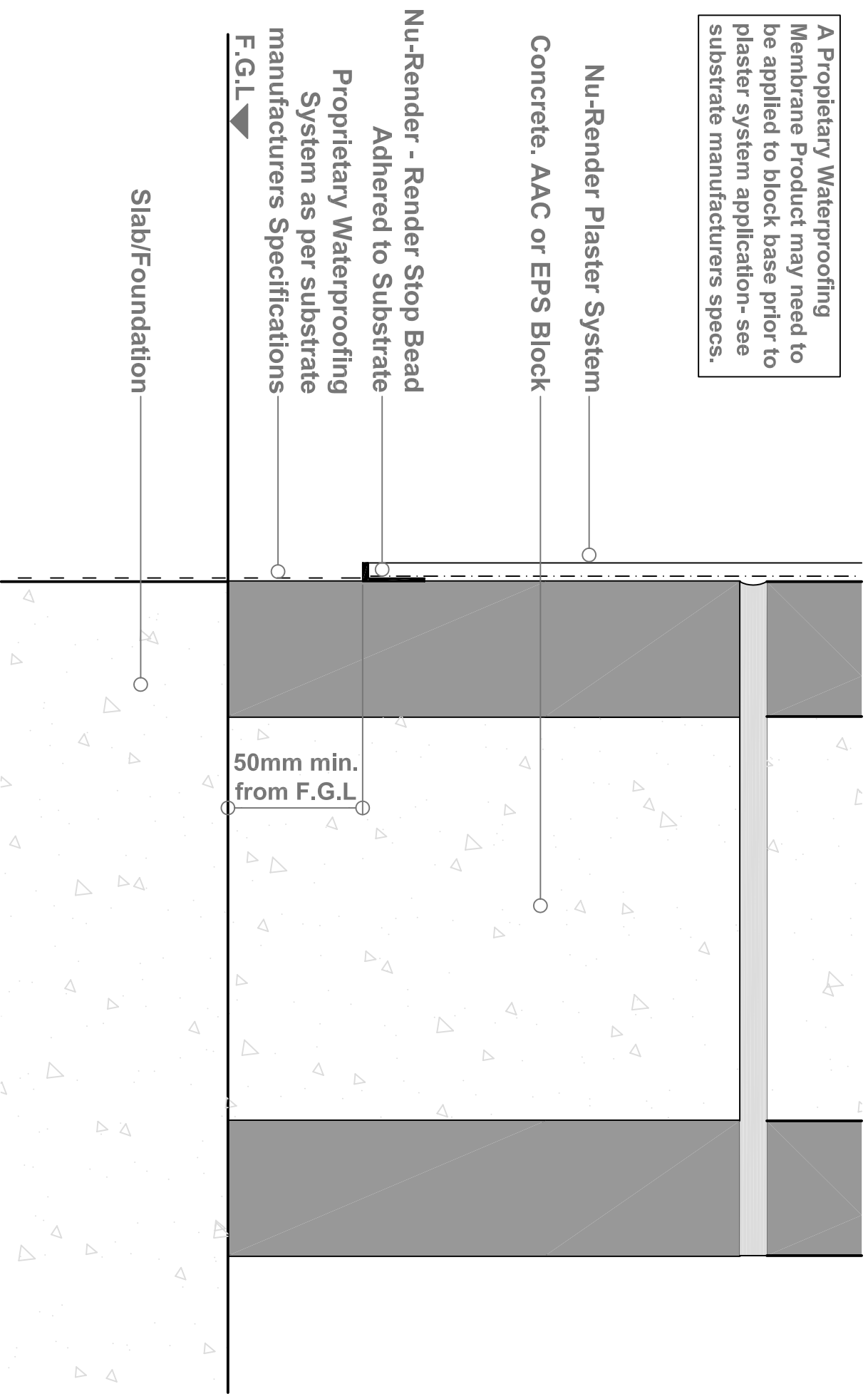

Slab/Foundation

Nu-Render Plaster System

Concrete. AAC or EPS Block

Nu-Render - Render Stop Bead  
Adhered to Substrate

Proprietary Waterproofing System as per substrate manufacturers Specifications

F.G.L. ▼

50mm min.  
from F.G.L.

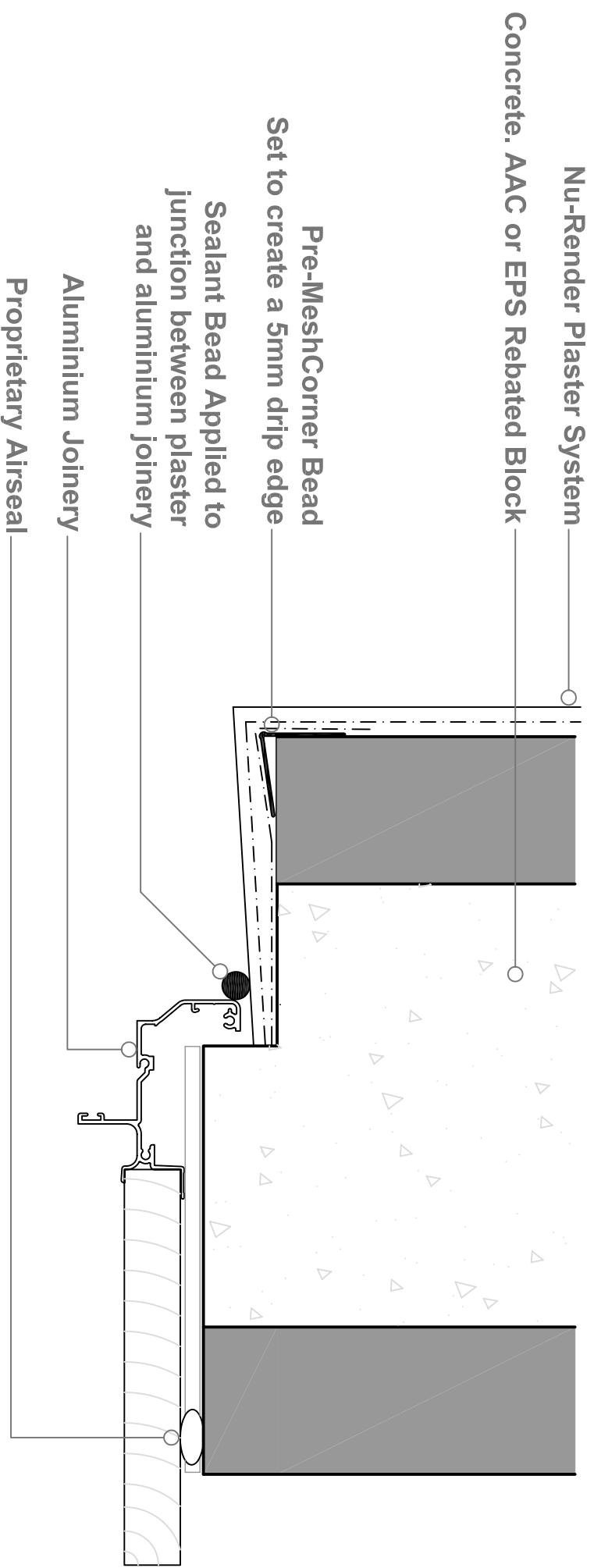

A Proprietary Waterproofing Membrane Product may need to be applied to block reveals prior to plaster system application - see substrate manufacturers specifications

A Proprietary Waterproofing Membrane Product may need to be applied to block rebate prior to plaster system application - see substrate manufacturers specifications

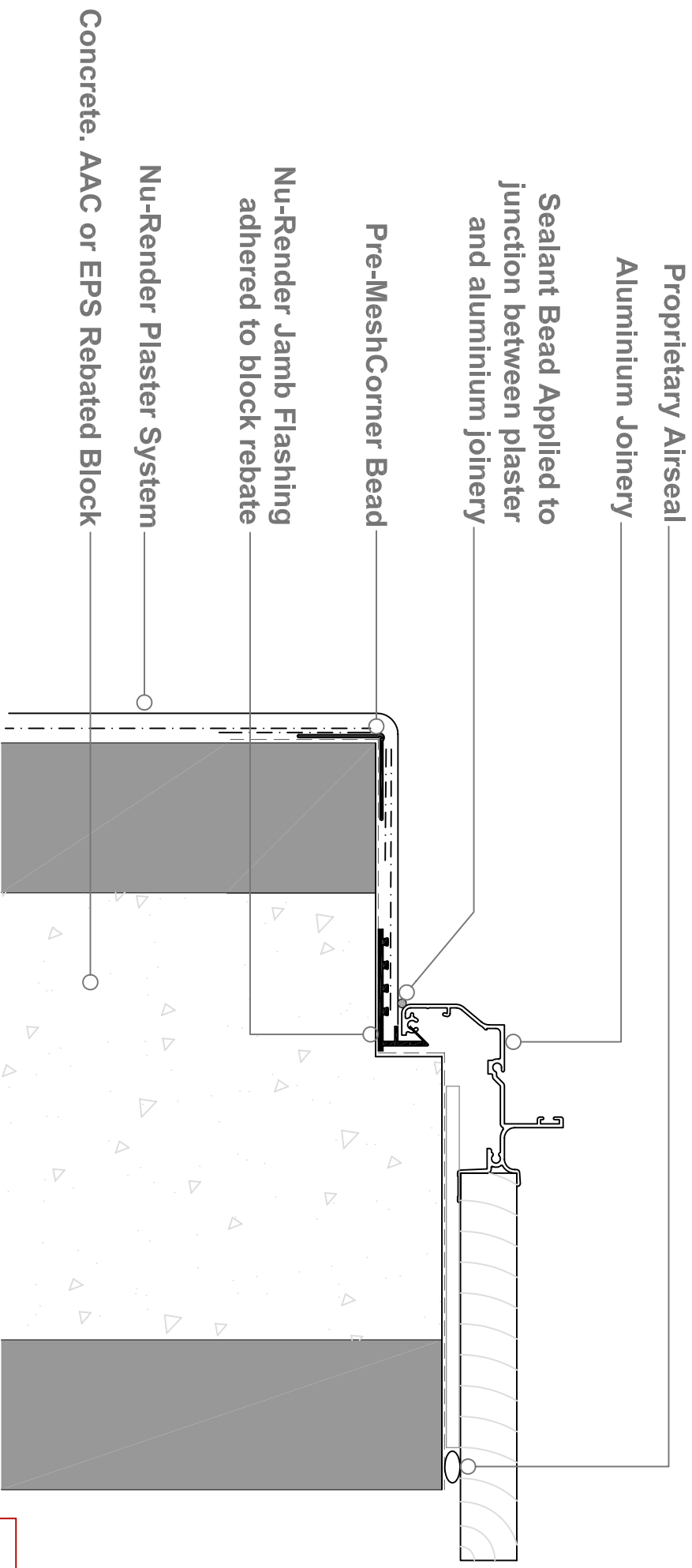

A Proprietary Waterproofing Membrane /Product may need to be applied to block reveals prior to plaster system application- see substrate manufacturers specifications

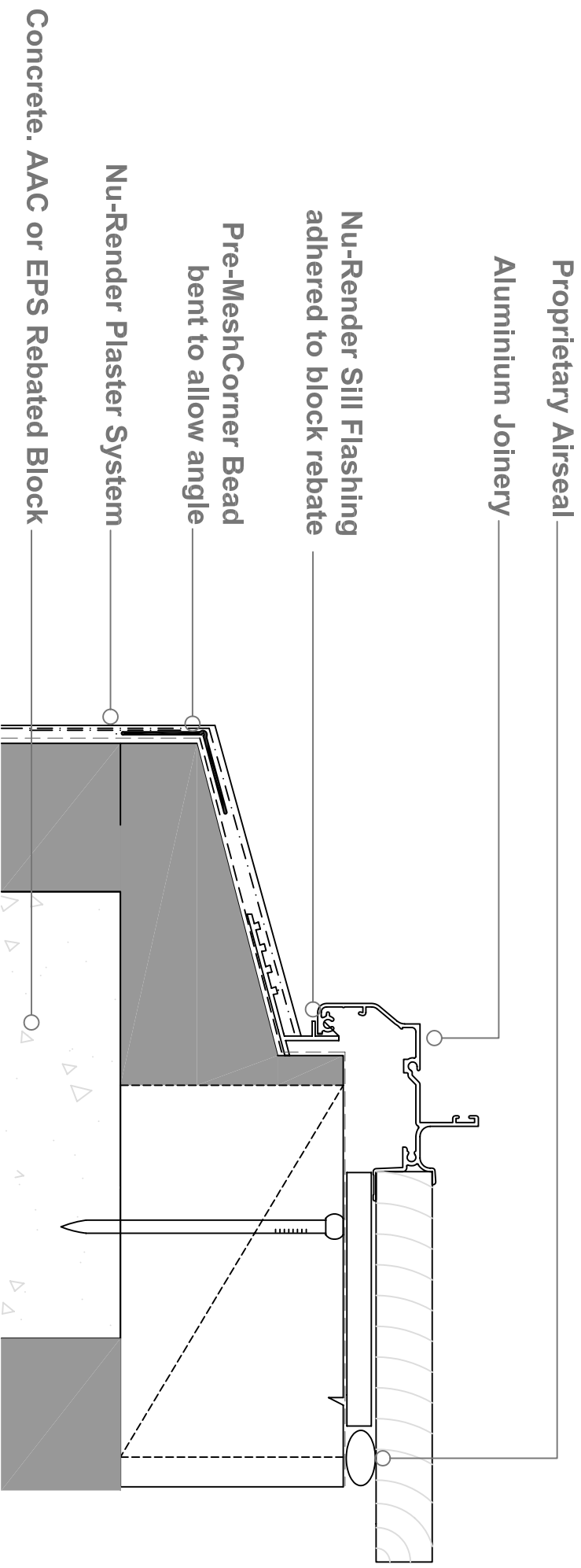

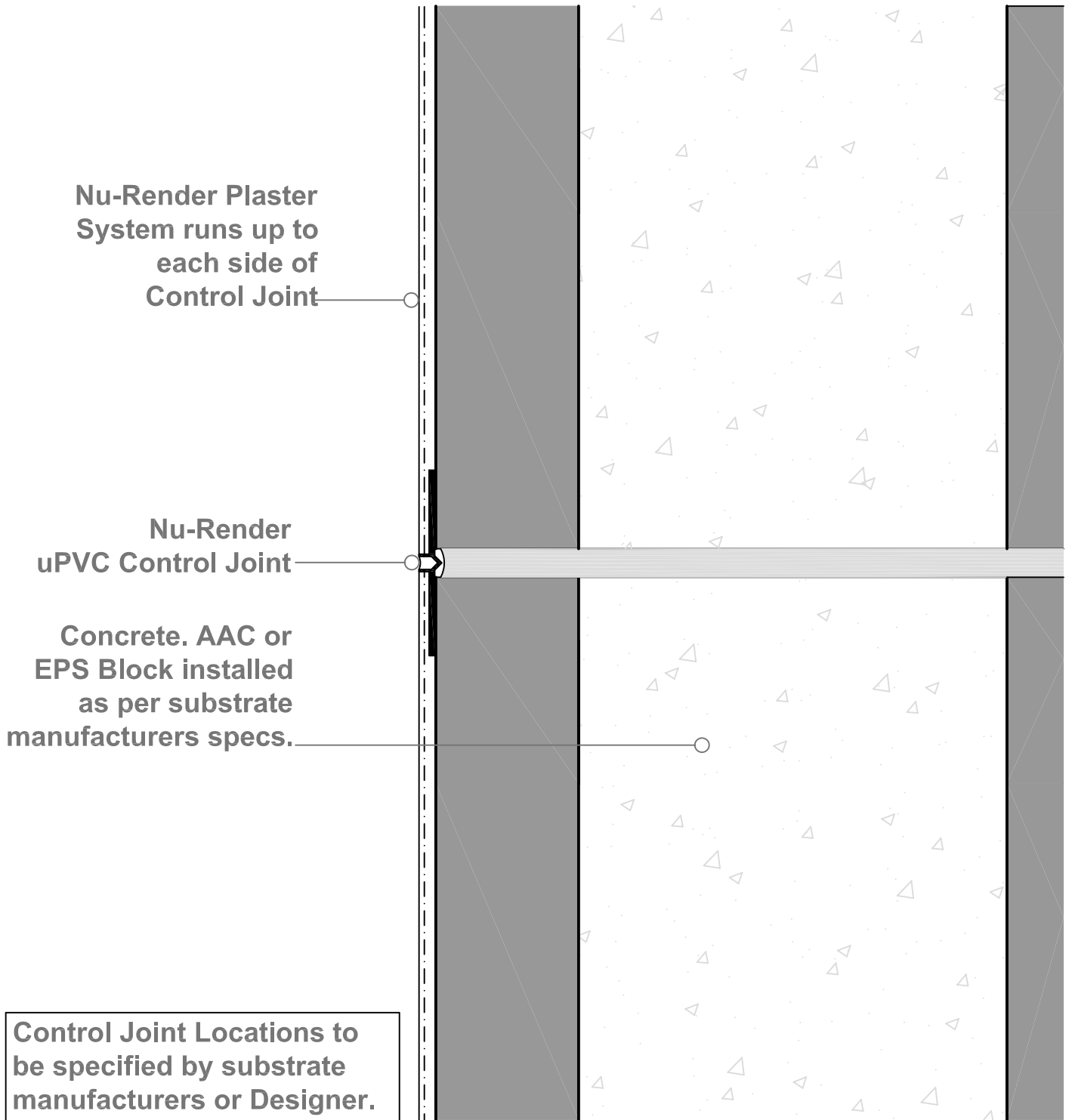

Nu-Render Plaster System runs up to each side of Control Joint

Nu-Render uPVC Control Joint

Concrete, AAC or EPS Block installed as per substrate manufacturers specs.

Control Joint Locations to be specified by substrate manufacturers or Designer.

Control Joint may be filled with sealant after Nu-Render application

## 6. INSTALLATION INSTRUCTIONS

### 6.1 Substrate

See manufacturer's documentation for installation instructions.

- The surface of the substrate must be free of dust, laitance, release oils and soil prior to the application of plaster.
- Any protrusions/boils of concrete/mortar etc must be removed from substrate prior to plaster application.
- AAC substrates must be sealed prior to plaster application with GranoPrime. See GranoPrime TDS for application and thinning requirements.

### 6.2 Flashings

#### Control Joints

- Control joint locations to be specified by substrate manufacturer. Control joints must be adhered to the substrate using a suitable BRANZ Appraised Construction Adhesive, Granosite / Nu-Age Thin Bed Render or Adhesive Mortar Coarse Leveling Coat is then applied over the 'wings' (but not continuous across control joint) of the component to lock it in place.
- These components are set to protrude the required plaster thickness allowing the plaster to butt up to either side of the control joint providing a controlled break in the Nu-Render Cladding Solution. These components may be filled with sealant (Optional) and painted upon completion of the plaster application.

### 6.3 Window flashings

- To be detailed and specified by designer
- Watty Granosite / Nu-Age Plaster supplies Flashing Components available for use around window and door openings. Watty Granosite / Nu-Age Plaster supplies said flashings in good faith for use with the Nu-Render System. The designer and substrate manufacturer must satisfy themselves when using these flashings and assume responsibility for weatherproofing openings in the substrate. See Section 4 uPVC Flashing Components.

### 6.4 Meshed Corner Beads

- Meshed corner beads are compulsory and are positioned on external corners and at all jamb and sill locations on doors and window openings to provide additional reinforcement of the plaster at these high risk impact points.
- The beads are cut to length and adhered to the external corner on top of the substrate using a suitable BRANZ Appraised Construction Adhesive, Granosite / Nu-Age Thin Bed render or Adhesive Mortar Coarse is then applied by dabbing the product through the bead and onto the wall approximately 100mm down from the top of the bead and 500mm thereafter to hold the bead in place. (The Granosite / Nu-Age Thin Bed Render or Adhesive Mortar Coarse leveling coat is applied over the entire meshed portions during plastering)
- Meshed corner beads are set to protrude approx. 5mm from adjacent wall planes and can be used by the applicator as screed guides for the leveling coat.

## 6.5 Plaster

### Preparation Prior to Application of Plaster

- All external corners and recessed window and door jambs must be reinforced with Meshed corner beads.
- Wall plane should be checked with a straight edge and should comply with the tolerances set out in the substrate manufacturer's specifications.
- Ensure all window and door joinery is wiped clean with a primer or cleaning agent as recommended by the sealant manufacturer prior to sealant application.
- Masking tape must be used to protect all joinery, soffit linings, guttering roofs etc which may be subject to splashing and overspray.
- The surface of the substrate must be free of dust, laitance, release oils and soil prior to the application of plaster.
- Any protrusions/boils of concrete/mortar etc must be removed from substrate prior to plaster application.

### Note:

Plastering should not take place when outside temperatures are or are considered to be within the next 24 hours outside the temperature range of 5-35°C.

### Mixing of Plaster

- Granosite / Nu-Age Plaster bagged products are supplied in 25kg bags and must be mixed with approx. 3-4 litres (or as required to achieve a workable mix) of clean fresh water without the introduction of any additional external materials.
- Mixing, if by hand must be carried out in accordance with NZS 4251 Clause 2.4.3.4 however machine mixing is recommended to produce a more consistent quality mix.
- Mixing using a D20 set the water pressure for approx 300-400 litres/tonne or as required to achieve a workable mix.
- Mixing must be carried out in accordance with the instructions on the back of each bag, together with those of the mixing machine manufacturer.
- All tools and mixing equipment to be washed cleaned frequently.



**M-Tec D20 Mixing Machine**

### **Application of Plaster — General**

Application must be carried out by a Watty/ Granosite / Nu-Age Plaster Trained Applicator to qualify for the 10 year Manufacturers Warrantee.

- Application must be carried out in accordance with the instructions stated in the Nu-Render Technical Literature
- All Granosite / Nu-Age plasters may be trowel applied but machine application is recommended to give better quality results.
- Any plaster not used within one hour of mixing must be discarded.
- Plaster must be applied only if the air temperature is between 5°C and 35°C at the time of application and is likely to remain so for the 24 hours following the application. Plaster should be applied on the shady side of the building following the path of the sun. If this is not possible shade cloths must be used.
- Plaster surfaces must be protected from rain and hot drying winds for at Least 24 hours following application.
- Each plaster coat must be cured in accordance with the instructions on the stated in the relevant Technical Literature, prior to the application of the next plaster coat. A controlled rate of drying is required to prevent cracking of the plaster.
- Following the commencement of plaster application it is essential that no vibration (e.g. nailing of internal linings) be permitted to the substrates supporting the plaster until at least seven (7) days following application of the plaster. Preferably no vibration to be made to the wall structure following plaster application.

### **Levelling Coat of Granosite / Nu-Age Thin Bed Render or Adhesive Mortar Coarse**

- The Granosite / Nu-Age Thin Bed Render or Adhesive Mortar Coarse Leveling coat is applied directly onto the substrate (preferably pumped) then screeded using an 'H' aluminium straight edge 1.2-2m long to a thickness of 3-5mm.
- Using the Meshed Corner beads as a guide to achieve correct thickness, high spots in the Granosite / Nu-Age Thin Bed Render or Adhesive Mortar Coarse leveling coat can be 'cut back' using a trapezium, checking for straightness horizontally and vertically.
- One 25kg bag of Granosite / Nu-Age Thin Bed Render or Adhesive Mortar Coarse will cover an area of approximately 3-4msq. at a thickness of 5mm.
- Granosite / Nu-Age Thin Bed Render or Adhesive Mortar Coarse must be protected from rain for the first 24 hours and from hot drying winds and direct sun for the first 16 hours to aid curing.

### **Granosite / Nu-Age Intermediate Coat**

- Granosite / Nu-Age Thin Bed Render/Adh. Mortar Coarse is applied approximately 2mm thick over the Granosite / Nu-Age Thin Bed Render or Adhesive Mortar Coarse leveling coat.
- It can then be ruled and floated to give a fine smooth surface ready to apply the selected texture. This Intermediate coat may be deleted if a heavier texture is being applied to the system.
- A 25 kg bag of Granosite / Nu-Age Thin Bed Render/Adh. Mortar Coarse at a thickness of 2mm will cover approximately 8-10msq.
- Granosite / Nu-Age Thin Bed Render/Adh. Mortar Coarse must be protected from rain for the first 24 hours and from hot drying winds and direct sun for the first 16 hours to aid curing.

### **Finishing Coats**

These consist of:

- Granosite / Nu-Age Fine Float Finish
- Granosite / Nu-Age Fine Sponge Finish
  
- Granosite / Nu-Age Medium Float Finish
- Granosite / Nu-Age Medium Sponge Finish
- Granosite / Nu-Age Medium Scratch/Drag/Swirl Finish
  
- Granosite / Nu-Age Coarse Float Finish
- Granosite / Nu-Age Coarse Scratch/Drag/Swirl Finish
  
- Granosite / Nu-Age Adobe Finish
  
- Granosite Acrylic Textures

### **Applying Granosite / Nu-Age Fine Float Finish**

- This is done by applying the plaster over a determined set area.
- The plaster is lightly trowelled tight to the wall.
- A hard plastic float is then used to achieve a float finish
- A 25 kg bag of Granosite / Nu-Age 1mm Sponge Finish at a thickness of 2mm will cover approximately 8-10msq.

### **Applying Granosite / Nu-Age Fine Sponge Finish**

- This is done by applying the plaster over a determined set area.
- The plaster is lightly trowelled tight to the wall.
- A hard plastic float is then used to achieve a even surface.
- A sponge is then used to bring up the texture of the product and finish the wall.
- A 25 kg bag of Granosite / Nu-Age 1mm Sponge Finish at a thickness of 2mm will cover approximately 8-10msq.

### **Applying Granosite / Nu-Age Medium Finish**

- This is done by applying the plaster over a determined set area.
- The plaster is lightly troweled tight to the wall.
- A specialised float is then used to achieve a even surface.
- A sponge can then be used to further bring up the texture of the product and finish the wall.
- A 25 kg bag of Granosite / Nu-Age Medium Sponge Finish at a thickness of 2-3mm will cover approximately 6-7msq.

### **Applying Granosite / Nu-Age Medium Scratch/Drag/Swirl Finish**

- This is done by applying the plaster over a determined set area.
- The plaster is lightly trowelled tight to the wall.
- A variety of specialised floats are then used to and floated in either a vertical, horizontal or circular pattern to achieve the required finished texture/pattern.
- A 25 kg bag of Granosite / Nu-Age Medium Scratch/Drag/Swirl Finish at a thickness of 2-3mm will cover approximately 6-7msq.

### **Applying Granosite / Nu-Age Coarse Finish**

- This is done by applying the plaster over a determined set area.
- The plaster is lightly trowelled tight to the wall.
- A specialized float is then used to achieve the desired finish
- A sponge can then be used to further bring up the texture of the product and finish the wall.
- A 25 kg bag of Granosite / Nu-Age Medium Float Finish at a thickness of 3-4mm will cover approximately 5-6msq.

### **Applying Granosite / Nu-Age Coarse Scratch/Drag/Swirl Finish**

- This is done by applying the plaster over a determined set area.
- The plaster is lightly trowelled tight to the wall.
- A variety of specialised floats are then used to and floated in either a vertical, horizontal or circular pattern to achieve the required finish.
- A 25 kg bag of Granosite / Nu-Age Medium Scratch/Drag/Swirl Finish at a thickness of 3-4mm will cover approximately 5-6msq.

### **Applying Granosite / Nu-Age Adobe Finish**

- Granosite / Nu-Age Adobe finish is applied over Granosite / Nu-Age Adh. Mortar Coarse or Thin Bed Render and is used to create a variety of sculptured finishes. Application can be done by two methods.

#### **The first method:**

- By applying the Granosite / Nu-Age Adobe over a determined set area at 3-5mm.
- Then a trowel is used to create a sculptured trowel finish.

#### **The second method:**

- Utilise the same procedure as above, then use a sponge to create a textured sandy effect.
- A 25 kg bag of Granosite / Nu-Age Adobe at a thickness of 3-5mm will cover approximately 3-4msq.

**All finishes must be protected from rain for the first 24 hours and from hot drying winds and direct sun for the first 16 hours to aid curing.**

- **Follow instructions on back of the bag for curing times.**

### **Applying Watty Granosite Acrylic Textures**

See Watty Granosite Paintworks Specification Manual.

### **6.6 Health and Safety**

Watty Granosite / Nu-Age Plaster requires the use of safety gear and accessories while installing the plaster system. The use of breather type devices containing filters to limit small particles from being inhaled is recommended. Wash excess plaster powder from skin with soap and water. Keep out of reach of children. Seek medical advice if plaster is ingested.

### **6.7 Maintenance**

- Inspections of the complete cladding surface should be carried out regularly.
- Any cracks or damaged areas, including flashings, beads and seals which have deteriorated, must be repaired immediately.
- Any damage to the substrate must be repaired in accordance with the substrate manufacturer's instructions, followed by re-plastering and repainting as per the original installation.
- The Nu-render system will need to be maintained in accordance with the Watty Granosite Maintenance Schedule.

## 7. AREAS WHERE ADDITIONAL CARE IS REQUIRED

### 7.1 Intersection with other claddings

- Special care is required at junctions with other claddings. The accurate design of these junctions is critical to prohibit water from entering the building envelope. These details are the responsibility of the building designer.
- Watty! Granosite / Nu-Age Plaster may have published details available for use at these points. Contact your local Watty! Granosite representative for further information.

### 7.3 Damage to cladding system

- Any damage or cracking of the cladding system (including the protective paint coating/AcrylicTexture) will require immediate attention and repair in order to prohibit water entry – Contact Watty! Granosite for repair.

### 7.4 Penetrations

- Any pipe, electrical or other penetrations must be sealed in a conduit pipe to protect and seal penetrations through the cladding.
  - Proprietary Waterproofing membranes may be required around penetrations through the cladding.
- See Section 5.5 for appropriate products.

### 7.5 Ground clearances

- Installed over Clay Brick and Masonry, AAC and EPS Block the bottom edge of the Nu-Render system should be kept clear of ground level by 50mm with the installation of a uPVC Render Stop or alternatively an aluminium 'Z' flashing at this point.
  - For sheet/panel type substrates the ground clearances to finished floor levels as set out in NZS 3604 must be adhered to at all times.
  - Instances where the Nu-Render Plaster System must run continually over a change of substrate (areas such as the edge of a concrete slab onto the wall cladding substrate etc.) the plaster system may be installed with the understanding that any substrate movement will likely create cracking in the plaster system. In this instance a control or relief joint should be installed.
- Watty! Granosite / Nu-Age Plaster cannot be held liable for cracking of the plaster due to substrate movement.

### 7.6 Substrate curing times

See substrate manufacturer's specifications for the required curing times for mortar joints etc. Allow sufficient time after laying/installation of substrate before applying force as per substrate manufacturers specifications i.e. Ladders etc.

### 7.7 Cavity Ventilation (applicable to certain Substrates only)

Watty! Granosite / Nu-Age Plaster recommends the use of proprietary vents at the required locations to provide consistent clean openings for the purpose of ventilating Brick cavities. These vents are installed during the substrate laying and are set to protrude the required finished plaster thickness. These units are the responsibility of the substrate manufacturers and/or substrate installers.

### 7.8 Substrate Movement

The Watty! Granosite / Nu-Age Plaster Nu-Render system can only provide monolithic aesthetics over the stated, substrate movement such as cracking of mortar joints, wall movement and settling of the building will cause undue stress on the Nu-Render system.

**Watty! Granosite / Nu-Age Plaster cannot be held liable for cracking or damage of the Nu-Render system caused by substrate movement.**

# Paintworks Specification GS 405.1NZ

<b>System</b>	<b>Grano Adobe Finish Satin</b>
<b>Substrate</b>	<b>Exterior – New and uncoated off form concrete</b>
<b>Category</b>	<b>Premium Texture – Water Based</b>

## Product Features

Grano Adobe Finish® is a high performance pre blended modified cement based texturing material designed for use over Grano Adhesive Mortar® (G1.06NZ) or Grano Modified Render® (G1.10NZ). Grano Adobe Finish allows various undulating and sculptured finishes to be achieved

## Surface Preparation

Ensure all new cementitious substrates are fully cured prior to coating. Typically this may take a minimum of 4-6 weeks. There must be less than 15% moisture wood equivalent in the surface at the time of application to ensure optimum coating performance. The surface must not be subject to frequent wetting or hydrostatic pressure. Any foreign material that may affect adhesion must be removed prior to coating. Grind off any protruding formwork joints.

**Patching or Skimming Imperfections:** Examine surfaces closely for air holes and imperfections, fill or skim as required with a GranoPatch® Smooth (G1.04NZ), block down, allow to dry, sand back and dust off.

**Rendering:** Render surface with Grano Adhesive Mortar® (G1.06NZ) or Grano Modified Render® (G1.10NZ). Allow to cure 7 days.

Application Details	Data Sheet	Coverage	Film Thickness (microns)		Dry Times	
			Wet	Dry	Touch	Topcoat
First Coat: <b>Grano Adobe Finish</b> (equipment: trowel to the desired effect)	G1.20NZ	5.00Kg/M <sup>2</sup>	4000	-	15 min	7 days
Second Coat: <b>GranoPrime®</b> (equipment: roller or spray)	G1.02NZ	0.08 L/M <sup>2</sup>	80	20	2 hours	6 hours
Third & Fourth Coat: <b>GranoImpact®</b> (equipment: roller, for spray application refer the datasheet )	G2.01NZ	0.12 L/M <sup>2</sup>	125	60	4 hours	6 hours

## Recommended Uses

For exterior and interior use.

Grano Adobe Finish may be applied to off-form concrete Class 2 (AS 1510) or equivalent, cement rendered fair-faced flush-jointed concrete block and brickwork (common, clay, concrete), tilt-up and pre-cast concrete, proprietary fibre cement boards and Autoclaved Aerated Concrete (AAC). See the appropriate system specification sheet for further details.

## Additional Notes

Surface preparation is the responsibility of the Builder, Renovator or Main Contractor and the Applicator. To achieve the indicated performance, it must be carried out according to Watty's recommendations.

It is recommended that application be carried out by a skilled applicator, who is totally conversant with the Watty Granosite products and systems, to validate full material warranty conditions.

## Caution

Provide adequate ventilation during use.

Application **should not** be carried out if the air temperature or the substrate temperature is below 10°C or above 35°C. The temperature must not fall below 10°C during the drying process.

1. This information is provided with respect to the listed Watty products. Watty recommends that:

(a) you review the Technical Data Sheets (TDS) and Material Safety Data Sheets (MSDS) before you use or handle the product; (b) the product be used only in accordance with the information provided by Watty; (c) the product be transported, stored and handled in accordance with the information on the MSDS and relevant TDS; and (d) you thoroughly test the product, using the recommended application method on a sample of intended substrate, before using the product.

2. The information in this specification sheet was prepared using information gathered during product development. While Watty endeavours to update this information and maintain the accuracy and currency of its contents, Watty cannot guarantee that the information provided is wholly comprehensive.

3. Watty recommends that you conduct such additional investigations as may be necessary to satisfy yourself of the accuracy, currency and comprehensiveness of the information on which you rely in using and handling the product. If you require further information please contact your nearest Watty Office.

4. To the full extent permitted by law, Watty's liability for breach of a condition or warranty implied into the contract for sale between Watty and you by law is limited at Watty's election to: (a) the replacement of the product; or (b) payment of the cost of replacing the product.

# Paintworks Specification GS 405.3NZ

<b>System</b>	<b>Grano Adobe Finish Satin</b>
<b>Substrate</b>	<b>Exterior – New and uncoated brick &amp; concrete block</b>
<b>Category</b>	<b>Premium Texture – Water Based</b>

## Product Features

Grano Adobe Finish® is a high performance pre blended modified cement based texturing material designed for use over Grano Adhesive Mortar® (G1.06NZ) or Grano Thin Bed Render (G1.09NZ) or Grano Skimcoat (G1.11NZ). Grano Adobe Finish allows various undulating and sculptured finishes to be achieved

## Surface Preparation

Substrate must be free from dirt, dust, oil, grease, mould or any other contaminants that may affect adhesion. All scaling, efflorescence, mould, mastic compound or any other foreign material must be removed prior to painting. Remove all traces of loosely adhering material by scraping, grinding or wire brushing, etc.

The success of any system is very much dependent on the correct construction of the framing, the installation/laying, fixing of the brick and concrete block and the application of the rendering materials themselves. Wattyl recommends that it is the responsibility of the Applicator to ensure that the substrate is of an acceptable standard prior to the application of any Granosite coating system.

Surface preparation is the responsibility of the Builder, Renovator or Main Contractor and the Applicator.

Render the new and uncoated brick & concrete blocks with the Grano Nu-Render or Nu-Solid rendering system for new and uncoated brick & concrete blocks. To access the Grano Nu-Render or Nu-Solid Installation Guides, contact Wattyl (NZ) Ltd for the regional Granosite Sales Consultant's contact details.

Application Details	Data Sheet	Coverage	Film Thickness (microns)		Dry Times	
			Wet	Dry	Touch	Topcoat
First Coat: <b>Grano Adobe Finish</b> <i>(equipment: trowel to the desired effect)</i>	G1.20NZ	5.00Kg/M <sup>2</sup>	4000	-	15 min	7 days
Second Coat: <b>GranoPrime®</b> <i>(equipment: roller or spray)</i>	G1.02NZ	0.08 L/M <sup>2</sup>	80	20	2 hours	6 hours
Third & Fourth Coat: <b>GranoImpact®</b> <i>(equipment: roller, for spray application refer the datasheet)</i>	G2.01NZ	0.12 L/M <sup>2</sup>	125	60	4 hours	6 hours

## Recommended Uses

For exterior and interior use.

Grano Adobe Finish may be applied to off-form concrete Class 2 (AS 1510) or equivalent, cement rendered fair-faced flush-jointed concrete block and brickwork (common, clay, concrete), tilt-up and pre-cast concrete, proprietary fibre cement boards and Autoclaved Aerated Concrete (AAC). See the appropriate system specification sheet for further details.

## Additional Notes

Surface preparation is the responsibility of the Builder, Renovator or Main Contractor and the Applicator. To achieve the indicated performance, it must be carried out according to Wattyl's recommendations.

It is recommended that application be carried out by a skilled applicator, who is totally conversant with the Wattyl Granosite products and systems, to validate full material warranty conditions.

## Caution

Provide adequate ventilation during use.

Application **should not** be carried out if the air temperature or the substrate temperature is below 10°C or above 35°C. The temperature must not fall below 10°C during the drying process.

1. This information is provided with respect to the listed Wattyl products. Wattyl recommends that:

(a) you review the Technical Data Sheets (TDS) and Material Safety Data Sheets (MSDS) before you use or handle the product; (b) the product be used only in accordance with the information provided by Wattyl; (c) the product be transported, stored and handled in accordance with the information on the MSDS and relevant TDS; and (d) you thoroughly test the product, using the recommended application method on a sample of intended substrate, before using the product.

2. The information in this specification sheet was prepared using information gathered during product development. While Wattyl endeavours to update this information and maintain the accuracy and currency of its contents, Wattyl cannot guarantee that the information provided is wholly comprehensive.

3. Wattyl recommends that you conduct such additional investigations as may be necessary to satisfy yourself of the accuracy, currency and comprehensiveness of the information on which you rely in using and handling the product. If you require further information please contact your nearest Wattyl Office.

4. To the full extent permitted by law, Wattyl's liability for breach of a condition or warranty implied into the contract for sale between Wattyl and you by law is limited at Wattyl's election to: (a) the replacement of the product; or (b) payment of the cost of replacing the product.

# Paintworks Specification GS 405.4NZ

<b>System</b>	<b>Grano Adobe Finish Satin</b>
<b>Substrate</b>	<b>Exterior – New and uncoated tilt-up &amp; pre-cast panels</b>
<b>Category</b>	<b>Premium Texture – Water Based</b>

## Product Features

Grano Adobe Finish® is a high performance pre blended modified cement based texturing material designed for use over Grano Adhesive Mortar® (G1.06NZ) or Grano Modified Render® (G1.10NZ). Grano Adobe Finish allows various undulating and sculptured finishes to be achieved

## Surface Preparation

The surface must be free from bondbreakers, release agents, dirt, dust, or other contaminants that may interfere with adhesion. Bondbreakers or release agents must be removed with a suitable proprietary cleaner as recommended by the tilt slab manufacturer. To test for bondbreakers, wet the surface. If the water beads and runs off, the bondbreaker has not been removed. If the water soaks into the surface the bondbreaker has been removed. Grind off any protruding formwork joints. Examine for air holes and defects, fill with GranoPatch® Smooth (G1.04NZ), block down, sand to an even finish, dust off.

**Rendering:** Render surface with Grano Adhesive Mortar® (G1.06NZ). Allow to cure 7 days.

Ensure all new cementitious substrates are fully cured prior to coating. Typically this may take a minimum of 4-6 weeks. There must be less than 15% moisture wood equivalent in the surface at the time of application to ensure optimum coating performance

Application Details	Data Sheet	Coverage	Film Thickness (microns)		Dry Times	
			Wet	Dry	Touch	Topcoat
First Coat: <b>Grano Adobe Finish</b> <i>(equipment: trowel to the desired effect)</i>	G1.20NZ	5.00Kg/M <sup>2</sup>	4000	-	15 min	7 days
Second Coat: <b>GranoPrime®</b> <i>(equipment: roller or spray)</i>	G1.02NZ	0.08 L/M <sup>2</sup>	80	20	2 hours	6 hours
Third & Fourth Coat: <b>GranoImpact®</b> <i>(equipment: roller, for spray application refer the datasheet)</i>	G2.01NZ	0.12 L/M <sup>2</sup>	125	60	4 hours	6 hours

## Recommended Uses

For exterior and interior use.

Grano Adobe Finish may be applied to off-form concrete Class 2 (AS 1510) or equivalent, cement rendered fair-faced flush-jointed concrete block and brickwork (common, clay, concrete), tilt-up and pre-cast concrete, proprietary fibre cement boards and Autoclaved Aerated Concrete (AAC). See the appropriate system specification sheet for further details.

## Additional Notes

Surface preparation is the responsibility of the Builder, Renovator or Main Contractor and the Applicator. To achieve the indicated performance, it must be carried out according to Watty's recommendations.

It is recommended that application be carried out by a skilled applicator, who is totally conversant with the Watty's Granosite products and systems, to validate full material warranty conditions.

## Caution

Provide adequate ventilation during use.

Application **should not** be carried out if the air temperature or the substrate temperature is below 10°C or above 35°C. The temperature must not fall below 10°C during the drying process.

- This information is provided with respect to the listed Watty's products. Watty's recommends that: (a) you review the Technical Data Sheets (TDS) and Material Safety Data Sheets (MSDS) before you use or handle the product; (b) the product be used only in accordance with the information provided by Watty's; (c) the product be transported, stored and handled in accordance with the information on the MSDS and relevant TDS; and (d) you thoroughly test the product, using the recommended application method on a sample of intended substrate, before using the product.
- The information in this specification sheet was prepared using information gathered during product development. While Watty's endeavours to update this information and maintain the accuracy and currency of its contents, Watty's cannot guarantee that the information provided is wholly comprehensive.
- Watty's recommends that you conduct such additional investigations as may be necessary to satisfy yourself of the accuracy, currency and comprehensiveness of the information on which you rely in using and handling the product. If you require further information please contact your nearest Watty's Office.
- To the full extent permitted by law, Watty's liability for breach of a condition or warranty implied into the contract for sale between Watty's and you by law is limited at Watty's election to: (a) the replacement of the product; or (b) payment of the cost of replacing the product.

# Paintworks Specification GS 405.5NZ

<b>System</b>	<b>Grano Adobe Finish Satin</b>
<b>Substrate</b>	<b>Exterior – New and uncoated Autoclaved Aerated Concrete (AAC)</b>
<b>Category</b>	<b>Premium Texture – Water Based</b>

## Product Features

Grano Adobe Finish® is a high performance pre blended modified cement based texturing material designed for use over Grano Adhesive Mortar® (G1.06NZ) or Grano Modified Render® (G1.10NZ). Grano Adobe Finish allows various undulating and sculptured finishes to be achieved

## Surface Preparation

All scaling, efflorescence, mastic compound or any other contaminants that may affect adhesion must be removed prior to coating. Remove all traces of loosely adhering material by scraping/wire brushing. Sweep or air blow remaining particles from joints.

### Autoclaved Aerated Concrete (AAC) – Blocks & Panels

Seal surface with GranoSeal® (G1.14NZ), applying an even coat to the entire surface. Set stainless steel mesh or pre-mesh PVC corners on all external corners and around windows using an appropriate adhesive ensuring they are plumb, level and set to achieve a screed as required for Grano Adhesive Mortar® (G1.06NZ) or Grano Modified Render® (G1.10NZ). Do the same for control joint beads. Fill air holes and defects, with GranoPatch® Smooth (G1.04NZ), block down, sand and dust off. Render surface with Grano Adhesive Mortar® (G1.06NZ) or Grano Modified Render® (G1.10NZ), applying one coat to the entire surface, The fibreglass mesh is then trowelled into this coat embedding the mesh. All laps in mesh must be 100mm minimum, Place Mesh butterflies on all external corners around openings and penetration. To ensure that the fibreglass mesh is fully encapsulated an additional coat may be required. Note: the plaster should be applied on the shady side of the building following the path of the sun. Plaster surfaces must be protected from rain and hot drying winds for at least 24 hours following application. Allow to fully cure before the application of the texture/coating system.

Application Details	Data Sheet	Coverage	Film Thickness (microns)		Dry Times	
			Wet	Dry	Touch	Topcoat
First Coat: <b>Grano Adobe Finish</b> <i>(equipment: trowel to the desired effect)</i>	G1.20NZ	5.00Kg/M <sup>2</sup>	4000	-	15 min	7 days
Second Coat: <b>GranoPrime®</b> <i>(equipment: roller or spray)</i>	G1.02NZ	0.08 L/M <sup>2</sup>	80	20	2 hours	6 hours
Third & Fourth Coat: <b>GranoImpact®</b> <i>(equipment: roller, for spray application refer the datasheet)</i>	G2.01NZ	0.12 L/M <sup>2</sup>	125	60	4 hours	6 hours

## Recommended Uses

For exterior and interior use.

Grano Adobe Finish may be applied to off-form concrete Class 2 (AS 1510) or equivalent, cement rendered fair-faced flush-jointed concrete block and brickwork (common, clay, concrete), tilt-up and pre-cast concrete, proprietary fibre cement boards and Autoclaved Aerated Concrete (AAC). See the appropriate system specification sheet for further details.

## Additional Notes

Surface preparation is the responsibility of the Builder, Renovator or Main Contractor and the Applicator. To achieve the indicated performance, it must be carried out according to Watty's recommendations.

It is recommended that application be carried out by a skilled applicator, who is totally conversant with the Watty Granosite products and systems, to validate full material warranty conditions.

## Caution

Provide adequate ventilation during use.

Application **should not** be carried out if the air temperature or the substrate temperature is below 10°C or above 35°C. The temperature must not fall below 10°C during the drying process.

- This information is provided with respect to the listed Watty products. Watty recommends that:
  - you review the Technical Data Sheets (TDS) and Material Safety Data Sheets (MSDS) before you use or handle the product;
  - the product be used only in accordance with the information provided by Watty;
  - the product be transported, stored and handled in accordance with the information on the MSDS and relevant TDS; and
  - you thoroughly test the product, using the recommended application method on a sample of intended substrate, before using the product.
- The information in this specification sheet was prepared using information gathered during product development. While Watty endeavours to update this information and maintain the accuracy and currency of its contents, Watty cannot guarantee that the information provided is wholly comprehensive.
- Watty recommends that you conduct such additional investigations as may be necessary to satisfy yourself of the accuracy, currency and comprehensiveness of the information on which you rely in using and handling the product. If you require further information please contact your nearest Watty Office.
- To the full extent permitted by law, Watty's liability for breach of a condition or warranty implied into the contract for sale between Watty and you by law is limited at Watty's election to: (a) the replacement of the product; or (b) payment of the cost of replacing the product.

# Paintworks Specification GS 425.1NZ

<b>System</b>	<b>Grano Sponge Finish Satin</b>
<b>Substrate</b>	<b>Exterior – New and uncoated off form concrete</b>
<b>Category</b>	<b>Premium Texture – Water Based</b>

## Product Features

Grano Sponge Finish® is a high performance pre blended modified cement based texturing material designed for use over Grano Adhesive Mortar® (G1.06NZ) or Grano Modified Render® (G1.10NZ). Grano Sponge Finish allows sponge, floated and various finishes to be achieved

## Surface Preparation

Ensure all new cementitious substrates are fully cured prior to coating. Typically this may take a minimum of 4-6 weeks. There must be less than 15% moisture wood equivalent in the surface at the time of application to ensure optimum coating performance. The surface must not be subject to frequent wetting or hydrostatic pressure. Any foreign material that may affect adhesion must be removed prior to coating. Grind off any protruding formwork joints.

**Patching or Skimming Imperfections:** Examine surfaces closely for air holes and imperfections, fill or skim as required with a GranoPatch® Smooth (G1.04NZ), block down, allow to dry, sand back and dust off.

**Rendering:** Render surface with Grano Adhesive Mortar® (G1.06NZ). Allow to cure 7 days

Application Details	Data Sheet	Coverage	Film Thickness (microns)		Dry Times	
			Wet	Dry	Touch	Topcoat
First Coat: <b>Grano Sponge Finish</b> (equipment: sponge, float, trowel to the desired effect)	G1.25NZ	3.00Kg/M <sup>2</sup>	2000	-	15 min	7 days
Second Coat: <b>GranoPrime®</b> (equipment: roller or spray)	G1.02NZ	0.08 L/M <sup>2</sup>	80	20	2 hours	6 hours
Third & Fourth Coat: <b>GranoImpact®</b> (equipment: roller, for spray application refer the datasheet )	G2.01NZ	0.12 L/M <sup>2</sup>	125	60	4 hours	6 hours

## Recommended Uses

For exterior and interior use.

Grano Sponge Finish may be applied to off-form concrete Class 2 (AS 1510) or equivalent, cement rendered fair-faced flush-jointed concrete block and brickwork (common, clay, concrete), tilt-up and pre-cast concrete, proprietary fibre cement boards and Autoclaved Aerated Concrete (AAC). See the appropriate system specification sheet for further details.

## Additional Notes

Surface preparation is the responsibility of the Builder, Renovator or Main Contractor and the Applicator. To achieve the indicated performance, it must be carried out according to Watty's recommendations.

It is recommended that application be carried out by a skilled applicator, who is totally conversant with the Watty Granosite products and systems, to validate full material

## Caution

Provide adequate ventilation during use.

Application **should not** be carried out if the air temperature or the substrate temperature is below 10°C or above 35°C. The temperature must not fall below 10°C during the drying process.

1. This information is provided with respect to the listed Watty products. Watty recommends that:

(a) you review the Technical Data Sheets (TDS) and Material Safety Data Sheets (MSDS) before you use or handle the product; (b) the product be used only in accordance with the information provided by Watty; (c) the product be transported, stored and handled in accordance with the information on the MSDS and relevant TDS; and (d) you thoroughly test the product, using the recommended application method on a sample of intended substrate, before using the product.

2. The information in this specification sheet was prepared using information gathered during product development. While Watty endeavours to update this information and maintain the accuracy and currency of its contents, Watty cannot guarantee that the information provided is wholly comprehensive.

3. Watty recommends that you conduct such additional investigations as may be necessary to satisfy yourself of the accuracy, currency and comprehensiveness of the information on which you rely in using and handling the product. If you require further information please contact your nearest Watty Office.

4. To the full extent permitted by law, Watty's liability for breach of a condition or warranty implied into the contract for sale between Watty and you by law is limited at Watty's election to: (a) the replacement of the product; or (b) payment of the cost of replacing the product.

# Paintworks Specification GS 425.3NZ

<b>System</b>	<b>Grano Sponge Finish Satin</b>
<b>Substrate</b>	<b>Exterior – New and uncoated brick &amp; concrete block</b>
<b>Category</b>	<b>Premium Texture – Water Based</b>

## Product Features

Grano Sponge Finish® is a high performance pre blended modified cement based texturing material designed for use Grano Adhesive Mortar® (G1.06NZ) or Grano Thin Bed Render (G1.09NZ). Grano Sponge Finish allows sponge, floated and various finishes to be achieved

## Surface Preparation

Substrate must be free from dirt, dust, oil, grease, mould or any other contaminants that may affect adhesion. All scaling, efflorescence, mould, mastic compound or any other foreign material must be removed prior to painting. Remove all traces of loosely adhering material by scraping, grinding or wire brushing, etc.

The success of any system is very much dependent on the correct construction of the framing, the installation/laying, fixing of the brick and concrete block and the application of the rendering materials themselves. Wattyl recommends that it is the responsibility of the Applicator to ensure that the substrate is of an acceptable standard prior to the application of any Granosite coating system.

Surface preparation is the responsibility of the Builder, Renovator or Main Contractor and the Applicator.

Render the new and uncoated brick & concrete blocks with the Grano Nu-Render or Nu-Solid rendering system for new and uncoated brick & concrete blocks. To access the Grano Nu-Render or Nu-Solid Installation Guides, contact Wattyl (NZ) Ltd for the regional Granosite Sales Consultant's contact details.

Application Details	Data Sheet	Coverage	Film Thickness (microns)		Dry Times	
			Wet	Dry	Touch	Topcoat
First Coat: <b>Grano Sponge Finish</b> <i>(equipment: trowel to the desired effect)</i>	G1.25NZ	3.00Kg/M <sup>2</sup>	2000	-	15 min	7 days
Second Coat: <b>GranoPrime®</b> <i>(equipment: roller or spray)</i>	G1.02NZ	0.08 L/M <sup>2</sup>	80	20	2 hours	6 hours
Third & Fourth Coat: <b>GranoImpact®</b> <i>(equipment: roller, for spray application refer the datasheet)</i>	G2.01NZ	0.12 L/M <sup>2</sup>	125	60	4 hours	6 hours

## Recommended Uses

For exterior and interior use.

Grano Sponge Finish may be applied to off-form concrete Class 2 (AS 1510) or equivalent, cement rendered fair-faced flush-jointed concrete block and brickwork (common, clay, concrete), tilt-up and pre-cast concrete, proprietary fibre cement boards and Autoclaved Aerated Concrete (AAC). See the appropriate system specification sheet for further details.

## Additional Notes

Surface preparation is the responsibility of the Builder, Renovator or Main Contractor and the Applicator. To achieve the indicated performance, it must be carried out according to Wattyl's recommendations.

It is recommended that application be carried out by a skilled applicator, who is totally conversant with the Wattyl Granosite products and systems, to validate full material warranty conditions.

## Caution

Provide adequate ventilation during use.

Application **should not** be carried out if the air temperature or the substrate temperature is below 10°C or above 35°C. The temperature must not fall below 10°C during the drying process.

- This information is provided with respect to the listed Wattyl products. Wattyl recommends that:
  - you review the Technical Data Sheets (TDS) and Material Safety Data Sheets (MSDS) before you use or handle the product;
  - the product be used only in accordance with the information provided by Wattyl;
  - the product be transported, stored and handled in accordance with the information on the MSDS and relevant TDS;
  - you thoroughly test the product, using the recommended application method on a sample of intended substrate, before using the product.
- The information in this specification sheet was prepared using information gathered during product development. While Wattyl endeavours to update this information and maintain the accuracy and currency of its contents, Wattyl cannot guarantee that the information provided is wholly comprehensive.
- Wattyl recommends that you conduct such additional investigations as may be necessary to satisfy yourself of the accuracy, currency and comprehensiveness of the information on which you rely in using and handling the product. If you require further information please contact your nearest Wattyl Office.
- To the full extent permitted by law, Wattyl's liability for breach of a condition or warranty implied into the contract for sale between Wattyl and you by law is limited at Wattyl's election to: (a) the replacement of the product; or (b) payment of the cost of replacing the product.

# Paintworks Specification GS 425.4NZ

<b>System</b>	<b>Grano Sponge Finish Satin</b>
<b>Substrate</b>	<b>Exterior – New and uncoated tilt-up &amp; pre-cast panels</b>
<b>Category</b>	<b>Premium Texture – Water Based</b>

## Product Features

Grano Sponge Finish® is a high performance pre blended modified cement based texturing material designed for use over Grano Adhesive Mortar® (G1.06NZ) or Grano Modified Render® (G1.10NZ). Grano Sponge Finish allows sponge, floated and various finishes to be achieved

## Surface Preparation

The surface must be free from bondbreakers, release agents, dirt, dust, or other contaminants that may interfere with adhesion. Bondbreakers or release agents must be removed with a suitable proprietary cleaner as recommended by the tilt slab manufacturer. To test for bondbreakers, wet the surface. If the water beads and runs off, the bondbreaker has not been removed. If the water soaks into the surface the bondbreaker has been removed.

Grind off any protruding formwork joints. Examine for air holes and defects, fill with GranoPatch® Smooth (G1.04NZ), block down, sand to an even finish, dust off. Ensure all new cementitious substrates are fully cured prior to coating. Typically this may take a minimum of 4-6 weeks. There must be less than 15% moisture wood equivalent in the surface at the time of application to ensure optimum coating performance. Apply to all surfaces one full coat of GranoPrime S (G1.03NZ) as per datasheet instructions.

**Rendering if required:** Render surface with Grano Adhesive Mortar® (G1.06NZ). Allow to cure 7 days.

Application Details	Data Sheet	Coverage	Film Thickness (microns)		Dry Times	
			Wet	Dry	Touch	Topcoat
First Coat: <b>Grano Sponge Finish</b> <i>(equipment: trowel to the desired effect)</i>	G1.25NZ	3.00Kg/M <sup>2</sup>	2000	-	15 min	7 days
Second Coat: <b>GranoPrime®</b> <i>(equipment: roller or spray)</i>	G1.02NZ	0.08 L/M <sup>2</sup>	80	20	2 hours	6 hours
Third & Fourth Coat: <b>GranoImpact®</b> <i>(equipment: roller, for spray application refer the datasheet)</i>	G2.01NZ	0.12 L/M <sup>2</sup>	125	60	4 hours	6 hours

## Recommended Uses

For exterior and interior use.

Grano Adobe Finish may be applied to off-form concrete Class 2 (AS 1510) or equivalent, cement rendered fair-faced flush-jointed concrete block and brickwork (common, clay, concrete), tilt-up and pre-cast concrete, proprietary fibre cement boards and Autoclaved Aerated Concrete (AAC). See the appropriate system specification sheet for further details.

## Additional Notes

Surface preparation is the responsibility of the Builder, Renovator or Main Contractor and the Applicator. To achieve the indicated performance, it must be carried out according to Watty's recommendations.

It is recommended that application be carried out by a skilled applicator, who is totally conversant with the Watty Grano products and systems, to validate full material warranty conditions

## Caution

Provide adequate ventilation during use.

Application **should not** be carried out if the air temperature or the substrate temperature is below 10°C or above 35°C. The temperature must not fall below 10°C during the drying process.

- This information is provided with respect to the listed Watty products. Watty recommends that:
  - you review the Technical Data Sheets (TDS) and Material Safety Data Sheets (MSDS) before you use or handle the product;
  - the product be used only in accordance with the information provided by Watty;
  - the product be transported, stored and handled in accordance with the information on the MSDS and relevant TDS; and
  - you thoroughly test the product, using the recommended application method on a sample of intended substrate, before using the product.
- The information in this specification sheet was prepared using information gathered during product development. While Watty endeavours to update this information and maintain the accuracy and currency of its contents, Watty cannot guarantee that the information provided is wholly comprehensive.
- Watty recommends that you conduct such additional investigations as may be necessary to satisfy yourself of the accuracy, currency and comprehensiveness of the information on which you rely in using and handling the product. If you require further information please contact your nearest Watty Office.
- To the full extent permitted by law, Watty's liability for breach of a condition or warranty implied into the contract for sale between Watty and you by law is limited at Watty's election to: (a) the replacement of the product; or (b) payment of the cost of replacing the product.

# Paintworks Specification GS 425.5NZ

<b>System</b>	<b>Grano Sponge Finish Satin</b>
<b>Substrate</b>	<b>Exterior – New and uncoated Autoclaved Aerated Concrete (AAC)</b>
<b>Category</b>	<b>Premium Texture – Water Based</b>

## Product Features

Grano Sponge Finish® is a high performance pre blended modified cement based texturing material designed for use over Grano Adhesive Mortar® (G1.06NZ) or Grano Modified Render® (G1.10NZ). Grano Sponge Finish allows sponge, floated and various finishes to be achieved

## Surface Preparation

All scaling, efflorescence, mastic compound or any other contaminants that may affect adhesion must be removed prior to coating. Remove all traces of loosely adhering material by scraping/wire brushing. Sweep or air blow remaining particles from joints.

### Autoclaved Aerated Concrete (AAC) – Blocks & Panels

Seal surface with GranoSeal® (G1.14NZ), applying an even coat to the entire surface. Set stainless steel mesh or pre-mesh PVC corners on all external corners and around windows using an appropriate adhesive ensuring they are plumb, level and set to achieve a screed as required for Grano Adhesive Mortar® (G1.06NZ) or Grano Modified Render® (G1.10NZ). Do the same for control joint beads. Fill air holes and defects, with GranoPatch® Smooth (G1.04NZ), block down, sand and dust off. Render surface with Grano Adhesive Mortar® (G1.06NZ) or Grano Modified Render® (G1.10NZ), applying one coat to the entire surface. The fibreglass mesh is then trowelled into this coat embedding the mesh. All laps in mesh must be 100mm minimum, Place Mesh butterflies on all external corners around openings and penetration. To ensure that the fibreglass mesh is fully encapsulated an additional coat may be required. Note: the plaster should be applied on the shady side of the building following the path of the sun. Plaster surfaces must be protected from rain and hot drying winds for at least 24 hours following application. Allow to fully cure before the application of the texture/coating system.

Application Details	Data Sheet	Coverage	Film Thickness (microns)		Dry Times	
			Wet	Dry	Touch	Topcoat
First Coat: <b>Grano Sponge Finish</b> <i>(equipment: trowel to the desired effect)</i>	G1.25NZ	3.00Kg/M <sup>2</sup>	2000	-	15 min	7 days
Second Coat: <b>GranoPrime®</b> <i>(equipment: roller or spray)</i>	G1.02NZ	0.08 L/M <sup>2</sup>	80	20	2 hours	6 hours
Third & Fourth Coat: <b>GranoImpact®</b> <i>(equipment: roller, for spray application refer the datasheet)</i>	G2.01NZ	0.12 L/M <sup>2</sup>	125	60	4 hours	6 hours

## Recommended Uses

For exterior and interior use.

Grano Sponge Finish may be applied to off-form concrete Class 2 (AS 1510) or equivalent, cement rendered fair-faced flush-jointed concrete block and brickwork (common, clay, concrete), tilt-up and pre-cast concrete, proprietary fibre cement boards and Autoclaved Aerated Concrete (AAC). See the appropriate system specification sheet for further details.

## Additional Notes

Surface preparation is the responsibility of the Builder, Renovator or Main Contractor and the Applicator. To achieve the indicated performance, it must be carried out according to Watty's recommendations.

It is recommended that application be carried out by a skilled applicator, who is totally conversant with the Watty's Granosite products and systems, to validate full material warranty conditions.

## Caution

Provide adequate ventilation during use.

Application **should not** be carried out if the air temperature or the substrate temperature is below 10°C or above 35°C. The temperature must not fall below 10°C during the drying process.

1. This information is provided with respect to the listed Watty products. Watty recommends that:

(a) you review the Technical Data Sheets (TDS) and Material Safety Data Sheets (MSDS) before you use or handle the product; (b) the product be used only in accordance with the information provided by Watty; (c) the product be transported, stored and handled in accordance with the information on the MSDS and relevant TDS; and (d) you thoroughly test the product, using the recommended application method on a sample of intended substrate, before using the product.

2. The information in this specification sheet was prepared using information gathered during product development. While Watty endeavours to update this information and maintain the accuracy and currency of its contents, Watty cannot guarantee that the information provided is wholly comprehensive.

3. Watty recommends that you conduct such additional investigations as may be necessary to satisfy yourself of the accuracy, currency and comprehensiveness of the information on which you rely in using and handling the product. If you require further information please contact your nearest Watty Office.

4. To the full extent permitted by law, Watty's liability for breach of a condition or warranty implied into the contract for sale between Watty and you by law is limited at Watty's election to: (a) the replacement of the product; or (b) payment of the cost of replacing the product.

# Paintworks Specification GS 430.3NZ

<b>System</b>	<b>Grano Adhesive Mortar Trowel Satin</b>
<b>Substrate</b>	<b>Exterior – New and uncoated brick &amp; concrete block</b>
<b>Category</b>	<b>Premium Texture – Water Based</b>

## Product Features

Grano Adhesive Mortar® Coarse or Fine is a high quality polymer modified, cementitious rendering and screeding material specifically designed for thin section rendering, it is also suitable for creating a sculptured trowel effects finishes

## Surface Preparation

Substrate must be free from dirt, dust, oil, grease, mould or any other contaminants that may affect adhesion. All scaling, efflorescence, mould, mastic compound or any other foreign material must be removed prior to painting. Remove all traces of loosely adhering material by scraping, grinding or wire brushing, etc.

The success of any system is very much dependent on the correct construction of the framing, the installation/laying, fixing of the brick and concrete block and the application of the rendering materials themselves. Watty! recommends that it is the responsibility of the Applicator to ensure that the substrate is of an acceptable standard prior to the application of any Granosite coating system.

Surface preparation is the responsibility of the Builder, Renovator or Main Contractor and the Applicator.

Render the new and uncoated brick & concrete blocks with the Grano Nu-Render or Nu-Solid rendering system for new and uncoated brick & concrete blocks. To access the Grano Nu-Render or Nu-Solid Installation Guides, contact Watty! (NZ) Ltd for the regional Granosite Sales Consultant's contact details.

Application Details	Data Sheet	Coverage	Film Thickness (microns)		Dry Times	
			Wet	Dry	Touch	Topcoat
First Coat: <b>Grano Adhesive Mortar Finish</b> <i>(equipment: trowel to the desired effect)</i>	G1.06NZ	5.00Kg/M <sup>2</sup>	5000	-	15 min	7 days
Second Coat: <b>GranoPrime®</b> <i>(equipment: roller or spray)</i>	G1.02NZ	0.08 L/M <sup>2</sup>	80	20	2 hours	6 hours
Third & Fourth Coat: <b>GranoImpact®</b> <i>(equipment: roller, for spray application refer the datasheet)</i>	G2.01NZ	0.12 L/M <sup>2</sup>	125	60	4 hours	6 hours

## Recommended Uses

For exterior and interior use.

Grano Adhesive Mortar may be applied to off-form concrete Class 2 (AS 1510) or equivalent, cement rendered fair-faced flush-jointed concrete block and brickwork (common, clay, concrete), tilt-up and pre-cast concrete, proprietary fibre cement boards and Autoclaved Aerated Concrete (AAC). See the appropriate system specification sheet for further details.

## Additional Notes

Surface preparation is the responsibility of the Builder, Renovator or Main Contractor and the Applicator. To achieve the indicated performance, it must be carried out according to Watty!'s recommendations.

It is recommended that application be carried out by a skilled applicator, who is totally conversant with the Watty! Granosite products and systems, to validate full material warranty conditions.

## Caution

Provide adequate ventilation during use.

Application **should not** be carried out if the air temperature or the substrate temperature is below 10°C or above 35°C. The temperature must not fall below 10°C during the drying process.

- This information is provided with respect to the listed Watty! products. Watty! recommends that:
  - you review the Technical Data Sheets (TDS) and Material Safety Data Sheets (MSDS) before you use or handle the product;
  - the product be used only in accordance with the information provided by Watty!;
  - the product be transported, stored and handled in accordance with the information on the MSDS and relevant TDS; and
  - you thoroughly test the product, using the recommended application method on a sample of intended substrate, before using the product.
- The information in this specification sheet was prepared using information gathered during product development. While Watty! endeavours to update this information and maintain the accuracy and currency of its contents, Watty! cannot guarantee that the information provided is wholly comprehensive.
- Watty! recommends that you conduct such additional investigations as may be necessary to satisfy yourself of the accuracy, currency and comprehensiveness of the information on which you rely in using and handling the product. If you require further information please contact your nearest Watty! Office.
- To the full extent permitted by law, Watty!'s liability for breach of a condition or warranty implied into the contract for sale between Watty! and you by law is limited at Watty!'s election to: (a) the replacement of the product; or (b) payment of the cost of replacing the product.

# Paintworks Specification GS 430.4NZ

<b>System</b>	<b>Grano Adhesive Mortar Trowel Satin</b>
<b>Substrate</b>	<b>Exterior – New and uncoated tilt-up &amp; pre-cast panels</b>
<b>Category</b>	<b>Premium Texture – Water Based</b>

## Product Features

Grano Adhesive Mortar® Coarse or Fine is a high quality polymer modified, cementitious rendering and screeding material specifically designed for thin section rendering, it is also suitable for creating a sculptured trowel effects finishes

## Surface Preparation

The surface must be free from bondbreakers, release agents, dirt, dust, or other contaminants that may interfere with adhesion. Bondbreakers or release agents must be removed with a suitable proprietary cleaner as recommended by the tilt slab manufacturer. To test for bondbreakers, wet the surface. If the water beads and runs off, the bondbreaker has not been removed. If the water soaks into the surface the bondbreaker has been removed.

Grind off any protruding formwork joints. Examine for air holes and defects, fill with GranoPatch® Smooth (G1.04NZ), block down, sand to an even finish, dust off.

Ensure all new cementitious substrates are fully cured prior to coating. Typically this may take a minimum of 4-6 weeks. There must be less than 15% moisture wood equivalent in the surface at the time of application to ensure optimum coating performance.

Application Details	Data Sheet	Coverage	Film Thickness (microns)		Dry Times	
			Wet	Dry	Touch	Topcoat
First Coat: <b>Grano Adhesive Mortar Finish</b> <i>(equipment: trowel to the desired effect)</i>	G1.06NZ	5.00Kg/M <sup>2</sup>	5000	-	15 min	7 days
Second Coat: <b>GranoPrime®</b> <i>(equipment: roller or spray)</i>	G1.02NZ	0.08 L/M <sup>2</sup>	80	20	2 hours	6 hours
Third & Fourth Coat: <b>GranoImpact®</b> <i>(equipment: roller, for spray application refer the datasheet)</i>	G2.01NZ	0.12 L/M <sup>2</sup>	125	60	4 hours	6 hours

## Recommended Uses

For exterior and interior use.

Grano Adhesive Mortar may be applied to off-form concrete Class 2 (AS 1510) or equivalent, cement rendered fair-faced flush-jointed concrete block and brickwork (common, clay, concrete), tilt-up and pre-cast concrete, proprietary fibre cement boards and Autoclaved Aerated Concrete (AAC). See the appropriate system specification sheet for further details.

## Additional Notes

Surface preparation is the responsibility of the Builder, Renovator or Main Contractor and the Applicator. To achieve the indicated performance, it must be carried out according to Watty's recommendations.

It is recommended that application be carried out by a skilled applicator, who is totally conversant with the Watty's Granosite products and systems, to validate full material warranty conditions.

## Caution

Provide adequate ventilation during use.

Application **should not** be carried out if the air temperature or the substrate temperature is below 10°C or above 35°C. The temperature must not fall below 10°C during the drying process.

1. This information is provided with respect to the listed Watty products. Watty recommends that:

(a) you review the Technical Data Sheets (TDS) and Material Safety Data Sheets (MSDS) before you use or handle the product; (b) the product be used only in accordance with the information provided by Watty; (c) the product be transported, stored and handled in accordance with the information on the MSDS and relevant TDS; and (d) you thoroughly test the product, using the recommended application method on a sample of intended substrate, before using the product.

2. The information in this specification sheet was prepared using information gathered during product development. While Watty endeavours to update this information and maintain the accuracy and currency of its contents, Watty cannot guarantee that the information provided is wholly comprehensive.

3. Watty recommends that you conduct such additional investigations as may be necessary to satisfy yourself of the accuracy, currency and comprehensiveness of the information on which you rely in using and handling the product. If you require further information please contact your nearest Watty Office.

4. To the full extent permitted by law, Watty's liability for breach of a condition or warranty implied into the contract for sale between Watty and you by law is limited at Watty's election to: (a) the replacement of the product; or (b) payment of the cost of replacing the product.

# Paintworks Specification GS 430.5NZ

<b>System</b>	<b>Grano Adhesive Mortar Trowel Satin</b>
<b>Substrate</b>	<b>Exterior – New and uncoated Autoclaved Aerated Concrete (AAC)</b>
<b>Category</b>	<b>Premium Texture – Water Based</b>

## Product Features

Grano Adhesive Mortar® Coarse or Fine is a high quality polymer modified, cementitious rendering and screeding material specifically designed for thin section rendering, it is also suitable for creating a sculptured trowel effects finishes

## Surface Preparation

All scaling, efflorescence, mastic compound or any other contaminants that may affect adhesion must be removed prior to coating. Remove all traces of loosely adhering material by scraping/wire brushing. Sweep or air blow remaining particles from joints.

### **Autoclaved Aerated Concrete (AAC) – Blocks & Panels**

Seal surface with GranoSeal® (G1.14NZ), applying an even coat to the entire surface. Set stainless steel mesh or pre-mesh PVC corners on all external corners and around windows using an appropriate adhesive ensuring they are plumb, level and set to achieve a screed as required for Grano Adhesive Mortar® (G1.06NZ) or Grano Modified Render® (G1.10NZ). Do the same for control joint beads. Fill air holes and defects, with GranoPatch® Smooth (G1.04NZ), block down, sand and dust off. Render surface with Grano Adhesive Mortar® (G1.06NZ) or Grano Modified Render® (G1.10NZ), applying one coat to the entire surface. The fibreglass mesh is then trowelled into this coat embedding the mesh. All laps in mesh must be 100mm minimum. Place Mesh butterflies on all external corners around openings and penetration. To ensure that the fibreglass mesh is fully encapsulated an additional coat may be required. Note: the plaster should be applied on the shady side of the building following the path of the sun. Plaster surfaces must be protected from rain and hot drying winds for at least 24 hours following application. Allow to fully cure before the application of the texture/coating system.

Application Details	Data Sheet	Coverage	Film Thickness (microns)		Dry Times	
			Wet	Dry	Touch	Topcoat
First Coat: <b>Grano Adhesive Mortar Finish</b> <i>(equipment: trowel to the desired effect)</i>	G1.06NZ	5.00Kg/M <sup>2</sup>	5000	-	15 min	7 days
Second Coat: <b>GranoPrime®</b> <i>(equipment: roller or spray)</i>	G1.02NZ	0.08 L/M <sup>2</sup>	80	20	2 hours	6 hours
Third & Fourth Coat: <b>GranoImpact®</b> <i>(equipment: roller, for spray application refer the datasheet)</i>	G2.01NZ	0.12 L/M <sup>2</sup>	125	60	4 hours	6 hours

## Recommended Uses

For exterior and interior use.

Grano Adhesive Mortar may be applied to off-form concrete Class 2 (AS 1510) or equivalent, cement rendered fair-faced flush-jointed concrete block and brickwork (common, clay, concrete), tilt-up and pre-cast concrete, proprietary fibre cement boards and Autoclaved Aerated Concrete (AAC). See the appropriate system specification sheet for further details.

## Additional Notes

Surface preparation is the responsibility of the Builder, Renovator or Main Contractor and the Applicator. To achieve the indicated performance, it must be carried out according to Watty's recommendations.

It is recommended that application be carried out by a skilled applicator, who is totally conversant with the Watty Granosite products and systems, to validate full material warranty conditions.

## Caution

Provide adequate ventilation during use.

Application **should not** be carried out if the air temperature or the substrate temperature is below 10°C or above 35°C. The temperature must not fall below 10°C during the drying process.

1. This information is provided with respect to the listed Watty products. Watty recommends that: (a) you review the Technical Data Sheets (TDS) and Material Safety Data Sheets (MSDS) before you use or handle the product; (b) the product be used only in accordance with the information provided by Watty; (c) the product be transported, stored and handled in accordance with the information on the MSDS and relevant TDS; and (d) you thoroughly test the product, using the recommended application method on a sample of intended substrate, before using the product.
2. The information in this specification sheet was prepared using information gathered during product development. While Watty endeavours to update this information and maintain the accuracy and currency of its contents, Watty cannot guarantee that the information provided is wholly comprehensive.
3. Watty recommends that you conduct such additional investigations as may be necessary to satisfy yourself of the accuracy, currency and comprehensiveness of the information on which you rely in using and handling the product. If you require further information please contact your nearest Watty Office.
4. To the full extent permitted by law, Watty's liability for breach of a condition or warranty implied into the contract for sale between Watty and you by law is limited at Watty's election to: (a) the replacement of the product; or (b) payment of the cost of replacing the product.

# Grano Thin Bed Mortar

Page 1 of 2  
Resource Code  
April 2005

## DESCRIPTION

- Grano Thin Bed Mortar is a high quality polymer modified, cementitious rendering material specifically designed for thin section rendering on brick, blocks or over cementitious surfaces.

## PRINCIPAL CHARACTERISTICS

- Suitable for interior or exterior use.
- Applies with exceptional ease to provide a good adhesive surface for a finishing texture or plaster.
- Can be applied between 3-5mm thicknesses in one application.
- Superior application and adhesion properties when compared to conventional sand and cement render.
- Easy to apply and being pumpable can offer economies in time and labour.
- As a finish texture

## COLOURS AND GLOSS

- Grey

## BASIC DATA AT 25°C

- **Surface Dry** 1 Hour
- **Recoat** Twenty four (24) hours, if required
- **Fully Cured** Five (5) days  
All figures are quoted at 25°C and 50% Relative Humidity. Drying will take longer at lower temperatures or higher relative humidity.
- **Consistency** Dry powder
- **Texture** Grainy
- **Pot-Life** Fifteen (15) minutes when mixed.
- **Coverage per coat** 4.00Kg/M<sup>2</sup> per 4mm film thickness
- **Clean-up** Thoroughly clean equipment with water.
- **Weatherability** Excellent
- **Abrasion Resistance** Excellent

## RECOMMENDED SUBSTRATE CONDITIONS AND TEMPERATURE

- Grano Thin Bed Mortar is suitable for application to off-form concrete and any other fair-faced, flush and straight laid concrete block or brickwork (common, clay).
- Surface Preparation is the responsibility of the Builder, Renovator or Main Contractor and the Applicator. To achieve the indicated performance, application must be carried out according to Watty's recommendations.
- Ensure the surface is clean and dry. All substrates must be free of dirt, grease, oil, mould, release agents, bondbreakers or any other contaminants that may interfere with adhesion. There must be less than 15% moisture Wood Equivalent in the surface at the time of coating to ensure optimum coating performance.
- **Note:** Porous substrates **must** be sealed with GranoSeal® (G1.14NZ) reduced 1:1 with water and applied by roller or spray at 0.12L/M<sup>2</sup> (8.3M<sup>2</sup>/L). Allow to dry 2-6 hours **prior** to applying Grano Thin Bed Mortar®.
- Application **should not** be carried out if the air temperature or the substrate temperature is below 5°C or above 35°C.
- Freshly applied material must be protected from frosts and rain for a minimum of forty eight (48) hours.
- Not suitable for walk on surfaces.

### INSTRUCTIONS FOR USE

- Mix one (1) 25 kg bag of Grano Thin Bed Mortar to approximately 4.0 litres of water. Add the powder to the water steadily and mix with a power stirrer until it is smooth and lump free. Grano Thin Bed Mortar® has a pot-life of fifteen (15) minutes when mixed.
  - Trowel one (1) coat of Grano Thin Bed Mortar using a stainless steel trowel at 4.00Kg/M<sup>2</sup> per 4mm film thickness. Allow 24 hours to dry.
  - Apply an additional coat of Grano Thin Bed Mortar if required.
- Curing**
- Keep damp for the first 12 hours to ensure full strength is developed. This is critical in windy conditions or when humidity is low.
  - Allow to fully cure for 24 hours or when moisture content is no greater than 15% wood equivalent before plaster or acrylic texture top coating.
  - For Nu-Therm or Nu-Lite systems refer the Installation Guide.

### SAFETY DATA

- **Caution** Provide adequate ventilation during use. Avoid inhalation of the powder, prolonged skin contact and particularly eye contact. Wear protective clothing to minimise skin contact and wear goggles where splatter is likely.
- **Spills and Disposal** Do not allow spill material to enter drains or other watercourses. Sweep up and dispose of waste in sealed containers to minimise dust. Disposal of waste is subject to statutory control. Consult your local authority for disposal guidelines.
- **M.S.D.S.** A Material Safety Data Sheet (M.S.D.S.) is available on request.
- **First Aid**  
If swallowed **do not** induce vomiting. Give plenty of water to drink. Contact a doctor or the Poisons Information Centre. Phone 0800 764766 (New Zealand).  
If in eyes, hold eyes open and flood with water for at least 15 minutes. Contact a doctor if any irritation occurs.  
If on skin remove contaminated clothing, wash skin thoroughly with soap and water or a proprietary skin cleanser. Do not use solvents.  
If affected by inhalation remove person to fresh air. If breathing difficulties persist or occur later, contact a doctor.

### ADDITIONAL DATA

- Available in 25 kg bags.
- Bags must be kept dry during transportation and storage.
- **Shelf Life:** Six (6) months if stored appropriately. This must include storage under cover, above ground, away from direct heat and moisture and in well-sealed containers.
- It is recommended that application be carried out by a skilled applicator, who is totally conversant with the Granosite products and systems, to validate full material warranty conditions.
- For further information, contact the WattyL Information Helpline. Phone 0800 735551 (New Zealand).

**GRANO THIN BED MORTAR IS A SURFACE PREPARATION PRODUCT AND IS USED IN CONJUNCTION WITH VARIOUS GRANOSITE SYSTEMS. AS SUCH IT IS NOT A SYSTEM IN ITSELF AND SHOULD ONLY BE USED WHERE SPECIFIED.**

1. This information is provided with respect to the listed WattyL products. WattyL recommends that:

(a) you review the Technical Data Sheets (TDS) and Material Safety Data Sheets (MSDS) before you use or handle the product; (b) the product be used only in accordance with the information provided by WattyL; (c) the product be transported, stored and handled in accordance with the information on the MSDS and relevant TDS; and (d) you thoroughly test the product, using the recommended application method on a sample of intended substrate, before using the product.

2. The information in this technical data sheet was prepared using information gathered during product development. While WattyL endeavours to update this information and maintain the accuracy and currency of its contents, WattyL cannot guarantee that the information provided is wholly comprehensive.

3. WattyL recommends that you conduct such additional investigations as may be necessary to satisfy yourself of the accuracy, currency and comprehensiveness of the information on which you rely in using and handling the product. If you require further information please contact your nearest WattyL Office.

4. To the full extent permitted by law, WattyL's liability for breach of a condition or warranty implied into the contract for sale between WattyL and you by law is limited at WattyL's election to: (a) the replacement of the product; or (b) payment of the cost of replacing the product.

# Grano Adhesive Mortar® formerly GranoPlast

Page 1 of 2  
Resource Code 849504  
July 2004

## DESCRIPTION

- Grano Adhesive Mortar® Coarse or Fine is a high quality polymer modified, cementitious rendering material specifically designed for thin section rendering on expanded polystyrene sheets or blocks, bricks, AAC or over a base coat render.

## PRINCIPAL CHARACTERISTICS

- Suitable for interior or exterior use.
- Applies with exceptional ease to provide a good adhesive surface for a finishing texture or plaster.
- Can be applied between 4-5mm thicknesses in one application.
- Superior application and adhesion properties when compared to conventional sand and cement render.
- Easy to apply and being pumpable can offer economies in time and labour.
- As a finish texture

## COLOURS AND GLOSS

- Grey

## BASIC DATA AT 25°C

- **Surface Dry** Fifteen (15) minutes
- **Recoat** Twenty four (24) hours, if required
- **Fully Cured** Seven (7) days  
All figures are quoted at 25°C and 50% Relative Humidity. Drying will take longer at lower temperatures or higher relative humidity.
- **Consistency** Dry powder
- **Texture** Grainy
- **Pot-Life** Fifteen (15) minutes when mixed.
- **Coverage per coat** 4.00Kg/M<sup>2</sup> per 4mm film thickness
- **Clean-up** Thoroughly clean equipment with water.
- **Weatherability** Excellent
- **Abrasion Resistance** Excellent

## RECOMMENDED SUBSTRATE CONDITIONS AND TEMPERATURE

- Grano Adhesive Mortar® is suitable for application to Expanded Extruded Polystyrene Sheets and Blocks, and Autoclaved Aerated Concrete (AAC) blocks or panels, off-form concrete and any other fair-faced, flush and straight laid concrete block or brickwork (common, clay).
- Surface Preparation is the responsibility of the Builder, Renovator or Main Contractor and the Applicator. To achieve the indicated performance, application must be carried out according to Watty's recommendations.
- Ensure the surface is clean and dry. All substrates must be free of dirt, grease, oil, mould, release agents, bondbreakers or any other contaminants that may interfere with adhesion. There must be less than 15% moisture Wood Equivalent in the surface at the time of coating to ensure optimum coating performance.
- **Note:** Porous substrates **must** be sealed with GranoSeal® (G1.14NZ) reduced 1:1 with water and applied by roller or spray at 0.12L/M<sup>2</sup> (8.3M<sup>2</sup>/L). Allow to dry 2-6 hours **prior** to applying Grano Adhesive Mortar®.
- Application **should not** be carried out if the air temperature or the substrate temperature is below 5°C or above 35°C.
- Freshly applied material must be protected from frosts and rain for a minimum of forty eight (48) hours.
- Not suitable for walk on surfaces.

### INSTRUCTIONS FOR USE

- Mix one (1) 25 kg bag of Grano Adhesive Mortar® to approximately 4.0 litres of water. Add the powder to the water steadily and mix with a power stirrer until it is smooth and lump free. Grano Adhesive Mortar® has a pot-life of fifteen (15) minutes when mixed.
- Trowel one (1) coat of Grano Adhesive Mortar® using a stainless steel trowel at 4.00Kg/M<sup>2</sup> per 4mm film thickness. Allow 24 hours to dry.
- Apply an additional coat of Grano Adhesive Mortar® if required.

#### Curing

- Keep damp for the first 12 hours to ensure full strength is developed. This is critical in windy conditions or when humidity is low.
- Allow to fully cure for 24 hours or when moisture content is no greater than 15% wood equivalent before top coating.
- For Nu-Therm or Nu-Lite systems refer the Installation Guide.

### SAFETY DATA

- **Caution** Provide adequate ventilation during use. Avoid inhalation of the powder, prolonged skin contact and particularly eye contact. Wear protective clothing to minimise skin contact and wear goggles where splatter is likely.
- **Spills and Disposal** Do not allow spill material to enter drains or other watercourses. Sweep up and dispose of waste in sealed containers to minimise dust. Disposal of waste is subject to statutory control. Consult your local authority for disposal guidelines.
- **M.S.D.S.** A Material Safety Data Sheet (M.S.D.S.) is available on request.
- **First Aid**  
If swallowed **do not** induce vomiting. Give plenty of water to drink. Contact a doctor or the Poisons Information Centre. Phone 0800 764766 (New Zealand).  
If in eyes, hold eyes open and flood with water for at least 15 minutes. Contact a doctor if any irritation occurs.  
If on skin remove contaminated clothing, wash skin thoroughly with soap and water or a proprietary skin cleanser. Do not use solvents.  
If affected by inhalation remove person to fresh air. If breathing difficulties persist or occur later, contact a doctor.

### ADDITIONAL DATA

- Available in 25 kg bags.
- Bags must be kept dry during transportation and storage.
- **Shelf Life:** Six (6) months if stored appropriately. This must include storage under cover, above ground, away from direct heat and moisture and in well-sealed containers.
- It is recommended that application be carried out by a skilled applicator, who is totally conversant with the Granosite products and systems, to validate full material warranty conditions.
- For further information, contact the Watty Information Helpline. Phone 0800 735551 (New Zealand).

**GRANO ADHESIVE MORTAR® IS A SURFACE PREPARATION PRODUCT AND IS USED IN CONJUNCTION WITH VARIOUS GRANOSITE SYSTEMS. AS SUCH IT IS NOT A SYSTEM IN ITSELF AND SHOULD ONLY BE USED WHERE SPECIFIED.**

1. This information is provided with respect to the listed Watty products. Watty recommends that:

(a) you review the Technical Data Sheets (TDS) and Material Safety Data Sheets (MSDS) before you use or handle the product; (b) the product be used only in accordance with the information provided by Watty; (c) the product be transported, stored and handled in accordance with the information on the MSDS and relevant TDS; and (d) you thoroughly test the product, using the recommended application method on a sample of intended substrate, before using the product.

2. The information in this technical data sheet was prepared using information gathered during product development. While Watty endeavours to update this information and maintain the accuracy and currency of its contents, Watty cannot guarantee that the information provided is wholly comprehensive.

3. Watty recommends that you conduct such additional investigations as may be necessary to satisfy yourself of the accuracy, currency and comprehensiveness of the information on which you rely in using and handling the product. If you require further information please contact your nearest Watty Office.

4. To the full extent permitted by law, Watty's liability for breach of a condition or warranty implied into the contract for sale between Watty and you by law is limited at Watty's election to: (a) the replacement of the product; or (b) payment of the cost of replacing the product.

# Grano Skim Coat

Page 1 of 2  
Resource Code  
April 2005

## DESCRIPTION

- Grano Skim Coat is a high quality pre-blended, cementitious rendering and screeding material specifically designed for finishing rendering of the base coat prior to application of Sponge or Adobe Finish.

## PRINCIPAL CHARACTERISTICS

- Suitable for interior or exterior use.
- Applies with exceptional ease to provide a base coat for finishing plasters.
- Can be applied between 2-4mm thicknesses in one application.
- Superior application and adhesion properties when compared to conventional sand and cement render.
- Easy to apply and being pumpable can offer economies in time and labour.

## COLOURS AND GLOSS

- Grey

## BASIC DATA AT 25°C

- **Surface Dry** Four (4) hours.
- **Recoat** Twenty four (24) hours, if required
- **Fully Cured** Seven (7) days  
All figures are quoted at 25°C and 50% Relative Humidity. Drying will take longer at lower temperatures or higher relative humidity.
- **Consistency** Dry powder
- **Texture** Grainy
- **Pot-Life** Fifteen (15) minutes when mixed
- **Coverage per coat** 7 Kg/M<sup>2</sup> per 3mm film thickness
- **Clean-up** Thoroughly clean equipment with water.
- **Weatherability** Excellent
- **Abrasion Resistance** Excellent

## RECOMMENDED SUBSTRATE CONDITIONS AND TEMPERATURE

- Grano Skim Coat is suitable for application to Grano Adhesive Mortar, Grano Modified Render or Grano Lite-weight Plaster.
- Surface Preparation is the responsibility of the Builder, Renovator or Main Contractor and the Applicator. To achieve the indicated performance, application must be carried out according to Wattyl's recommendations.
- Ensure the surface is clean and dry. All substrates must be free of dirt, grease, oil, mould, release agents, bondbreakers or any other contaminants that may interfere with adhesion. There must be less than 15% moisture Wood Equivalent in the surface at the time of coating to ensure optimum coating performance.
- Application **should not** be carried out if the air temperature or the substrate temperature is below 5°C or above 35°C.
- Freshly applied material must be protected from frosts and rain for a minimum of forty eight (48) hours.
- Not suitable for walk on surfaces.

## INSTRUCTIONS FOR USE

- Mix one (1) 25 kg bag of Grano Skim Coat to approximately 4.0 litres of water. Add the powder to the water steadily and mix with a power stirrer until it is smooth and lump free. Grano Skim Coat has a pot-life of fifteen (15) minutes when mixed.
- Trowel or pump one (1) coat of Grano Skim Coat @ Kg/M<sup>2</sup> per 3mm film thickness. Allow 24 hours to dry.

### INSTRUCTIONS FOR USE - Continued

#### Curing

- Keep damp for the first 12 hours to ensure full curing strength is developed. This is critical in windy conditions or when humidity is low.
- Allow to fully cure for 7 days or when moisture content is no greater than 15% wood equivalent before topcoating.

### SAFETY DATA

- **Caution** Provide adequate ventilation during use. Avoid inhalation of the powder, prolonged skin contact and particularly eye contact. Wear protective clothing to minimise skin contact and wear goggles where splatter is likely.
- **Spills and Disposal** Do not allow spilt material to enter drains or other watercourses. Sweep up and dispose of waste in sealed containers to minimise dust. Disposal of waste is subject to statutory control. Consult your local authority for disposal guidelines.
- **M.S.D.S.** A Material Safety Data Sheet (M.S.D.S.) is available on request.
- **First Aid**  
If swallowed **do not** induce vomiting. Give plenty of water to drink. Contact a doctor or the Poisons Information Centre. Phone 0800 764766 (New Zealand).  
If in eyes, hold eyes open and flood with water for at least 15 minutes. Contact a doctor if any irritation occurs.  
If on skin remove contaminated clothing, wash skin thoroughly with soap and water or a proprietary skin cleanser. Do not use solvents.  
If affected by inhalation remove person to fresh air. If breathing difficulties persist or occur later, contact a doctor.

### ADDITIONAL DATA

- Available in 25 kg bags.
- Bags must be dry during transport and storage.
- Bags must not be exposed to moisture, excessive heat or cold.
- **Shelf Life:** Six (6) months, if stored appropriately. This must include storage under cover, above ground, away from direct heat and moisture.
- It is recommended that application be carried out by a skilled applicator, who is totally conversant with the Granosite products and systems, to validate full material warranty conditions.
- For further information, contact the Watty Information Helpline. Phone 0800 735551 (New Zealand).

**GRANO SKIM COAT IS A SURFACE PREPARATION PRODUCT AND IS USED IN CONJUNCTION WITH VARIOUS GRANOSITE SYSTEMS. AS SUCH IT IS NOT A SYSTEM IN ITSELF AND SHOULD ONLY BE USED WHERE SPECIFIED.**

1. This information is provided with respect to the listed Watty products. Watty recommends that:

(a) you review the Technical Data Sheets (TDS) and Material Safety Data Sheets (MSDS) before you use or handle the product; (b) the product be used only in accordance with the information provided by Watty; (c) the product be transported, stored and handled in accordance with the information on the MSDS and relevant TDS; and (d) you thoroughly test the product, using the recommended application method on a sample of intended substrate, before using the product.

2. The information in this technical data sheet was prepared using information gathered during product development. While Watty endeavours to update this information and maintain the accuracy and currency of its contents, Watty cannot guarantee that the information provided is wholly comprehensive.

3. Watty recommends that you conduct such additional investigations as may be necessary to satisfy yourself of the accuracy, currency and comprehensiveness of the information on which you rely in using and handling the product. If you require further information please contact your nearest Watty Office.

4. To the full extent permitted by law, Watty's liability for breach of a condition or warranty implied into the contract for sale between Watty and you by law is limited at Watty's election to: (a) the replacement of the product; or (b) payment of the cost of replacing the product.

# Grano Sponge Finish® formerly GranoSponge

Page 1 of 2  
Resource Code  
October 2005

## DESCRIPTION

- Grano Sponge Finish® is a high performance pre blended modified cement based texturing material designed for use over Grano Adhesive Mortar® (G1.06NZ) or Grano Modified Render® (G1.10NZ).

## PRINCIPAL CHARACTERISTICS

- Suitable for interior or exterior use.
- Formulated to produce sponge, floated and various other finishes.
- Can be applied between 2-3mm thicknesses in one application.
- Easy to apply and can being pumpable can offer economies in time and labour

## COLOURS AND GLOSS

- Grey

## BASIC DATA AT 25°C

- **Surface Dry** 15 minutes
- **Recoat** Twenty four (24) hours, if required
- **Fully Cured** Seven (7) days  
All figures are quoted at 25°C and 50% Relative Humidity. Drying will take longer at lower temperatures or higher relative humidity.
- **Consistency** Dry powder
- **Texture** Grainy
- **Pot-Life** Two - Three (2-3) hours when mixed.
- **Coverage per coat** 3.00Kg/M<sup>2</sup> per 2mm film thickness
- **Clean-up** Thoroughly clean equipment with water.
- **Weatherability** Excellent
- **Abrasion Resistance** Excellent

## RECOMMENDED SUBSTRATE CONDITIONS AND TEMPERATURE

- Grano Sponge Finish® is suitable for application to rendered surfaces such as Grano Adhesive Mortar® (G1.06NZ) or Grano Modified Render® (G1.10NZ).
- Surface Preparation is the responsibility of the Builder, Renovator or Main Contractor and the Applicator. To achieve the indicated performance, application must be carried out according to Watty's recommendations.
- Ensure the surface is clean and dry. All substrates must be free of dirt, grease, oil, mould, release agents, bondbreakers or any other contaminants that may interfere with adhesion. There must be less than 15% moisture Wood Equivalent in the surface at the time of coating to ensure optimum coating performance.
- Application **should not** be carried out if the air temperature or the substrate temperature is below 5°C or above 35°C.
- Freshly applied material must be protected from frosts and rain for a minimum of forty eight (48) hours.
- Not suitable for walk on surfaces.

### INSTRUCTIONS FOR USE

- Mix one (1) 25 kg bag of Grano Sponge Finish® to approximately 4.0 litres of water. Add the powder to the water steadily and mix with a power stirrer until it is smooth and lump free. Grano Sponge Finish® has a pot-life of 15 minutes when mixed.
- Trowel one (1) coat of Grano Sponge Finish® using a stainless steel trowel at 3.00Kg/M<sup>2</sup> per 2mm film thickness. Allow 24 hours to dry.  
**Curing**
- Keep damp for the first 12 hours to ensure full strength is developed. This is critical in windy conditions or when humidity is low.
- Allow to fully cure for 7 days or when moisture content is no greater than 15% wood equivalent before top coating.

### SAFETY DATA

- **Caution** Provide adequate ventilation during use. Avoid inhalation of the powder, prolonged skin contact and particularly eye contact. Wear protective clothing to minimise skin contact and wear goggles where splatter is likely.
- **Spills and Disposal** Do not allow spill material to enter drains or other watercourses. Sweep up and dispose of waste in sealed containers to minimise dust. Disposal of waste is subject to statutory control. Consult your local authority for disposal guidelines.
- **M.S.D.S.** A Material Safety Data Sheet (M.S.D.S.) is available on request.
- **First Aid**  
If swallowed **do not** induce vomiting. Give plenty of water to drink. Contact a doctor or the Poisons Information Centre. Phone 0800 764766 (New Zealand).  
If in eyes, hold eyes open and flood with water for at least 15 minutes. Contact a doctor if any irritation occurs.  
If on skin remove contaminated clothing, wash skin thoroughly with soap and water or a proprietary skin cleanser. Do not use solvents.  
If affected by inhalation remove person to fresh air. If breathing difficulties persist or occur later, contact a doctor.

### ADDITIONAL DATA

- Available in 25 kg bags.
- Bags must be kept dry during transportation and storage.
- **Shelf Life:** Six (6) months if stored appropriately. This must include storage under cover, above ground, away from direct heat and moisture and in well-sealed containers.
- It is recommended that application be carried out by a skilled applicator, who is totally conversant with the Granosite products and systems, to validate full material warranty conditions.
- For further information, contact the Watty! Information Helpline. Phone 0800 735551 (New Zealand).

**GRANO SPONGE FINISH® IS A SURFACE PREPARATION PRODUCT AND IS USED IN CONJUNCTION WITH VARIOUS GRANOSITE SYSTEMS. AS SUCH IT IS NOT A SYSTEM IN ITSELF AND SHOULD ONLY BE USED WHERE SPECIFIED.**

1. This information is provided with respect to the listed Watty! products. Watty! recommends that:

(a) you review the Technical Data Sheets (TDS) and Material Safety Data Sheets (MSDS) before you use or handle the product; (b) the product be used only in accordance with the information provided by Watty!; (c) the product be transported, stored and handled in accordance with the information on the MSDS and relevant TDS; and (d) you thoroughly test the product, using the recommended application method on a sample of intended substrate, before using the product.

2. The information in this technical data sheet was prepared using information gathered during product development. While Watty! endeavours to update this information and maintain the accuracy and currency of its contents, Watty! cannot guarantee that the information provided is wholly comprehensive.

3. Watty! recommends that you conduct such additional investigations as may be necessary to satisfy yourself of the accuracy, currency and comprehensiveness of the information on which you rely in using and handling the product. If you require further information please contact your nearest Watty! Office.

4. To the full extent permitted by law, Watty!'s liability for breach of a condition or warranty implied into the contract for sale between Watty! and you by law is limited at Watty!'s election to: (a) the replacement of the product; or (b) payment of the cost of replacing the product.

# Grano Adobe Finish® formerly GranoAdobe

Page 1 of 2  
Resource Code  
July 2004

## DESCRIPTION

- Grano Adobe Finish® is a high performance pre blended modified cement based texturing material designed for use over Grano Adhesive Mortar® (G1.06NZ) or Grano Modified Render® (G1.10NZ).

## PRINCIPAL CHARACTERISTICS

- Suitable for interior or exterior use.
- Formulated to achieve various undulating or sculptured finishes.
- Can be applied between 3-5mm thicknesses in one application.
- Easy to apply and being pumpable can offer economies in time and labour

## COLOURS AND GLOSS

- Grey

## BASIC DATA AT 25°C

- **Surface Dry** 15 minutes
- **Recoat** Twenty four (24) hours, if required
- **Fully Cured** Seven (7) days  
All figures are quoted at 25°C and 50% Relative Humidity. Drying will take longer at lower temperatures or higher relative humidity.
- **Consistency** Dry powder
- **Texture** Grainy
- **Pot-Life** Fifteen (15) minutes when mixed.
- **Coverage per coat** 5.00Kg/M<sup>2</sup> per 4mm film thickness
- **Clean-up** Thoroughly clean equipment with water.
- **Weatherability** Excellent
- **Abrasion Resistance** Excellent

## RECOMMENDED SUBSTRATE CONDITIONS AND TEMPERATURE

- Grano Adobe Finish® is suitable for application to rendered surfaces such as Grano Adhesive Mortar® (G1.06NZ) or Grano Modified Render® (G1.10NZ).
- Surface Preparation is the responsibility of the Builder, Renovator or Main Contractor and the Applicator. To achieve the indicated performance, application must be carried out according to Watty's recommendations.
- Ensure the surface is clean and dry. All substrates must be free of dirt, grease, oil, mould, release agents, bondbreakers or any other contaminants that may interfere with adhesion. There must be less than 15% moisture Wood Equivalent in the surface at the time of coating to ensure optimum coating performance.
- Application **should not** be carried out if the air temperature or the substrate temperature is below 5°C or above 35°C.
- Freshly applied material must be protected from frosts and rain for a minimum of forty eight (48) hours.
- Not suitable for walk on surfaces.

### INSTRUCTIONS FOR USE

- Mix one (1) 25 kg bag of Grano Adobe Finish® to approximately 4.0 litres of water. Add the powder to the water steadily and mix with a power stirrer until it is smooth and lump free. Grano Adobe Finish® has a pot-life of fifteen (15) minutes when mixed.
- Trowel one (1) coat of Grano Adobe Finish ® using a stainless steel trowel at 4.00Kg/M<sup>2</sup> per 3mm film thickness. Allow 24 hours to dry.
- Apply an additional coat of Grano Adobe Finish ® if required.

#### Curing

- Keep damp for the first 12 hours to ensure full strength is developed. This is critical in windy conditions or when humidity is low.
- Allow to fully cure for 7 days or when moisture content is no greater than 15% wood equivalent before top coating.

### SAFETY DATA

- **Caution** Provide adequate ventilation during use. Avoid inhalation of the powder, prolonged skin contact and particularly eye contact. Wear protective clothing to minimise skin contact and wear goggles where splatter is likely.
- **Spills and Disposal** Do not allow spill material to enter drains or other watercourses. Sweep up and dispose of waste in sealed containers to minimise dust. Disposal of waste is subject to statutory control. Consult your local authority for disposal guidelines.
- **M.S.D.S.** A Material Safety Data Sheet (M.S.D.S.) is available on request.
- **First Aid**  
If swallowed **do not** induce vomiting. Give plenty of water to drink. Contact a doctor or the Poisons Information Centre. Phone 0800 764766 (New Zealand).  
If in eyes, hold eyes open and flood with water for at least 15 minutes. Contact a doctor if any irritation occurs.  
If on skin remove contaminated clothing, wash skin thoroughly with soap and water or a proprietary skin cleanser. Do not use solvents.  
If affected by inhalation remove person to fresh air. If breathing difficulties persist or occur later, contact a doctor.

### ADDITIONAL DATA

- Available in 25 kg bags.
- Bags must be kept dry during transportation and storage.
- **Shelf Life:** Six (6) months if stored appropriately. This must include storage under cover, above ground, away from direct heat and moisture and in well-sealed containers.
- It is recommended that application be carried out by a skilled applicator, who is totally conversant with the Granosite products and systems, to validate full material warranty conditions.
- For further information, contact the Watty Information Helpline. Phone 0800 735551 (New Zealand).

**GRANO ADOBE FINISH® IS A SURFACE PREPARATION PRODUCT AND IS USED IN CONJUNCTION WITH VARIOUS GRANOSITE SYSTEMS. AS SUCH IT IS NOT A SYSTEM IN ITSELF AND SHOULD ONLY BE USED WHERE SPECIFIED.**

1. This information is provided with respect to the listed Watty products. Watty recommends that:  
(a) you review the Technical Data Sheets (TDS) and Material Safety Data Sheets (MSDS) before you use or handle the product; (b) the product be used only in accordance with the information provided by Watty; (c) the product be transported, stored and handled in accordance with the information on the MSDS and relevant TDS; and (d) you thoroughly test the product, using the recommended application method on a sample of intended substrate, before using the product.  
2. The information in this technical data sheet was prepared using information gathered during product development. While Watty endeavours to update this information and maintain the accuracy and currency of its contents, Watty cannot guarantee that the information provided is wholly comprehensive.  
3. Watty recommends that you conduct such additional investigations as may be necessary to satisfy yourself of the accuracy, currency and comprehensiveness of the information on which you rely in using and handling the product. If you require further information please contact your nearest Watty Office.  
4. To the full extent permitted by law, Watty's liability for breach of a condition or warranty implied into the contract for sale between Watty and you by law is limited at Watty's election to: (a) the replacement of the product; or (b) payment of the cost of replacing the product.

# GranoPrime®

Page 1 of 2  
Resource Code 849405  
July 2004

## DESCRIPTION

- GranoPrime® is an acrylic primer sealer. GranoPrime® can be applied by brush, roller or spray, prior to the application of most of the Watty! Granosite texture systems.

## PRINCIPAL CHARACTERISTICS

- Suitable for interior or exterior use.
- Ensures optimum performance of the complete coating system by stabilising irregularities in substrate absorption and mechanical strength.
- Speeds the application, controls the drying and ensures strong adhesion of topcoats to the substrate.
- On concrete, cement render and mortar joints, the use of GranoPrime® minimises the threat of loss of adhesion or other problems that may arise due to presence of residual alkali salts.
- As an acrylic, GranoPrime® is not subject to the degradation that can occur with polyvinyl acetates (PVAs) in an alkaline environment.

## COLOURS AND GLOSS

- Off-white

## BASIC DATA AT 25°C

- **Surface Dry** Two (2) hours
- **Recoat** Two (2) to six (6) hours  
All figures are quoted at 25°C and 50% Relative Humidity. Drying will take longer at lower temperatures or higher relative humidity.
- **Density** 1.04 kg/L
- **Consistency** Milky liquid
- **Coverage per coat** 0.08L/M<sup>2</sup> (12.5M<sup>2</sup>/L)
- **Wet Film Thickness** 80 microns (approx)
- **Dry Film Thickness** 20 microns (approx)
- **Thinning**

High Absorption Substrates	Mix 1 part GranoPrime® with 1 part water.
Medium Absorption Substrates	Mix 2 parts GranoPrime® with 1 part water.
Low Absorption Substrates	Use GranoPrime® undiluted.
- **Clean-up** Thoroughly clean equipment with water.

## RECOMMENDED SUBSTRATE CONDITIONS AND TEMPERATURE

- **High Absorption Substrates:** Concrete block, cement render, brick, CFC and fibre cement sheeting, CSR™ Hebel® Autoclaved Aerated Concrete (AAC), coloured renders, lime washes, Grano Adhesive Mortar® (G1.06NZ), Grano Modified Render® (G1.10NZ), GranoReady Render® (G1.12NZ), GranoPatch Smooth (G1.04NZ), GranoFlex® (G1.15NZ).
- **Medium Absorption Substrates:** Off-form concrete under 40mpa, Polystyrene panels.
- **Low Absorption Substrates:** Previously painted surfaces, off-form concrete over 40mpa, high density bricks.
- GranoPrime® is **not suitable** for application to steel or timber substrates.
- Surface Preparation is the responsibility of the Builder, Renovator or Main Contractor and the Applicator. To achieve the indicated performance, application must be carried out according to Watty!'s recommendations.
- Ensure the surface is clean and dry. All substrates must be free of dirt, grease, oil, mould, release agents, bondbreakers or any other contaminants that may interfere with adhesion. Fresh concrete substrates should be left for a minimum of 28 days before coating; fresh plaster surfaces should be left for a minimum of 14 days. There must be less than 15% moisture Wood Equivalent in the surface at the time of coating to ensure optimum coating performance.
- Application **should not** be carried out if the air temperature or the substrate temperature is below 10°C or above 35°C. The temperature must not fall below 10°C during the drying process.
- Freshly applied material must be protected from frosts and rain for a minimum of forty eight (48) hours.

**INSTRUCTIONS FOR USE**

- Stir contents thoroughly with a power stirrer before use.
- Apply one (1) coat to a correctly prepared surface by brush, roller or spray.
- Airless Spray Settings: Tip - 519-521 Pressure - 1500 – 2000 psi

**SAFETY DATA**

- **Caution** Provide adequate ventilation during use.
- **Spills and Disposal** Do not allow spilt material to enter drains or other watercourses. Absorb spills with sand or other inert material. Unwanted paint should be kept in a sealed container, such as an empty paint can, and disposed of via special waste collection services. Check with your local Council regarding the disposal of empty paint containers
- **M.S.D.S.** A Material Safety Data Sheet (M.S.D.S.) is available on request.
- **First Aid**  
If swallowed **do not** induce vomiting. Give plenty of water to drink. Contact a doctor or the Poisons Information Centre. Phone 0800 764766 (New Zealand).  
If in eyes, hold eyes open and flood with water for at least 15 minutes. Contact a doctor if any irritation occurs.  
If on skin remove contaminated clothing, wash skin thoroughly with soap and water or a proprietary skin cleanser. Do not use solvents.  
If affected by inhalation remove person to fresh air. If breathing difficulties persist or occur later, contact a doctor.

**ADDITIONAL DATA**

- Available in 15 litre containers.
- Containers must be secured and stored upright during transit.
- Containers must not be exposed to excessive heat or cold.
- Storage must be under cover, away from direct heat, freezing and moisture, in well-sealed containers.
- It is recommended that application be carried out by a skilled applicator, who is totally conversant with the Granosite products and systems, to validate full material warranty conditions.
- For further information, contact the WattyL Information Helpline. Phone 0800 735551 (New Zealand).

**GRANOPRIME® IS A SURFACE PREPARATION PRODUCT AND IS USED IN CONJUNCTION WITH VARIOUS WATTYL GRANOSITE SYSTEMS. AS SUCH IT IS NOT A SYSTEM IN ITSELF AND SHOULD ONLY BE USED WHERE SPECIFIED.**

1. This information is provided with respect to the listed WattyL products. WattyL recommends that:

(a) you review the Technical Data Sheets (TDS) and Material Safety Data Sheets (MSDS) before you use or handle the product; (b) the product be used only in accordance with the information provided by WattyL; (c) the product be transported, stored and handled in accordance with the information on the MSDS and relevant TDS; and (d) you thoroughly test the product, using the recommended application method on a sample of intended substrate, before using the product.

2. The information in this technical data sheet was prepared using information gathered during product development. While WattyL endeavours to update this information and maintain the accuracy and currency of its contents, WattyL cannot guarantee that the information provided is wholly comprehensive.

3. WattyL recommends that you conduct such additional investigations as may be necessary to satisfy yourself of the accuracy, currency and comprehensiveness of the information on which you rely in using and handling the product. If you require further information please contact your nearest WattyL Office.

4. To the full extent permitted by law, WattyL's liability for breach of a condition or warranty implied into the contract for sale between WattyL and you by law is limited at WattyL's election to: (a) the replacement of the product; or (b) payment of the cost of replacing the product.



### BASIC DATA AT 25°C - continued

- **Early Fire Hazard (AS 1530.3)**

Ignitability	(0-20)	11
Spread of Flame	(0-10)	0
Heat Evolved	(0-10)	2
Smoke Developed	(0-10)	3
- **Thinning** Not required, but may be thinned with up to 10% water for cutting in and spray applications. Thinning rates for airless spray will vary according to the brand of equipment used.
- **Clean up** Thoroughly clean equipment with water.

### RECOMMENDED SUBSTRATE CONDITIONS AND TEMPERATURE

- GranolImpact® may be applied to off-form concrete Class 2 (AS 1510) or equivalent, cement rendered fair-faced flush-jointed concrete block and brickwork (common, clay, concrete), CFC, tilt-up and pre-cast concrete and paperfaced plasterboard. Make-good of the substrate is necessary if substrate imperfections are to be eliminated. Please refer to separate Datasheets for Grano Adhesive Mortar® (G1.06NZ) or Grano Modified Render® (G1.10NZ), GranoPatch® Smooth (G1.04NZ).
- Surface Preparation is the responsibility of the Builder, Renovator or Main Contractor and the Applicator. To achieve the indicated performance, application must be carried out according to Watty's recommendations.
- Ensure the surface is clean and dry. All substrates must be free of dirt, dust, grease, oil, mould release agents, bondbreakers and any other contaminants that may interfere with adhesion. Fresh concrete substrates should be left for a minimum of 28 days before coating; fresh plaster surfaces should be left for a minimum of 14 days. There must be less than 15% moisture Wood Equivalent in the surface at the time of coating to ensure optimum coating performance.
- Application **should not** be carried out if the air temperature or the substrate temperature is below 10°C or above 35°C. The temperature must not fall below 10°C during the drying process.
- Freshly applied material must be protected from frosts and rain for a minimum of forty eight (48) hours.
- Not suitable for roofs, ponds etc or walk on surfaces.
- For specific substrate preparation, see relevant specification sheets.

### INSTRUCTIONS FOR USE

- Stir contents thoroughly with a power stirrer before use.
- GranolImpact® is normally applied in a **two (2) coat** application by roller to achieve the desired texture finish or the specified dry film thickness to a correctly prepared and primed surface. GranolImpact® may be applied as a single finish coat on texture finishes over correctly prepared and primed surfaces by airless spray; however care must be taken to ensure an even overall finish is obtained.
- **AIRLESS GUN SETTINGS**

Tip	519 or 521	Pressure Setting	2500 to 3000 psi
-----	------------	------------------	------------------

### SAFETY DATA

- **Caution** Provide adequate ventilation during use.
- **Spills and Disposal** Do not allow spilt material to enter drains or other watercourses. Absorb spills with sand or other inert material. Unwanted paint should be kept in a sealed container, such as an empty paint can, and disposed of via special waste collection services. Check with your local Council regarding the disposal of empty paint containers
- **M.S.D.S.** A Material Safety Data Sheet (M.S.D.S.) is available on request.
- **First Aid**

If swallowed **do not** induce vomiting. Give plenty of water to drink. Contact a doctor or the Poisons Information Centre. Phone 0800 764766 (New Zealand).

If in eyes, hold eyes open and flood with water for at least 15 minutes. Contact a doctor if any irritation occurs.

If on skin remove contaminated clothing, wash skin thoroughly with soap and water or a proprietary skin cleanser. Do not use solvents.

If affected by inhalation remove person to fresh air. If breathing difficulties persist or occur later, contact a doctor.

### ADDITIONAL DATA

- Available in 15 litre containers.
- Containers must be secured and stored upright during transit.
- Containers must not be exposed to excessive heat or cold.
- Storage must be under cover, away from direct heat, freezing and moisture, in well-sealed containers.
- It is recommended that application be carried out by a skilled applicator, who is totally conversant with the Granosite products and systems, to validate full material warranty conditions.
- For further information, contact the Watty Information Helpline. Phone 0800 735551(New Zealand).

1. This information is provided with respect to the listed Watty products. Watty recommends that:  
(a) you review the Technical Data Sheets (TDS) and Material Safety Data Sheets (MSDS) before you use or handle the product; (b) the product be used only in accordance with the information provided by Watty; (c) the product be transported, stored and handled in accordance with the information on the MSDS and relevant TDS; and (d) you thoroughly test the product, using the recommended application method on a sample of intended substrate, before using the product.

2. The information in this technical data sheet was prepared using information gathered during product development. While Watty endeavours to update this information and maintain the accuracy and currency of its contents, Watty cannot guarantee that the information provided is wholly comprehensive.

3. Watty recommends that you conduct such additional investigations as may be necessary to satisfy yourself of the accuracy, currency and comprehensiveness of the information on which you rely in using and handling the product. If you require further information please contact your nearest Watty Office.

4. To the full extent permitted by law, Watty's liability for breach of a condition or warranty implied into the contract for sale between Watty and you by law is limited at Watty's election to: (a) the replacement of the product; or (b) payment of the cost of replacing the product.

## WARRANTY CONDITIONS

Wattyl Granosite® & Nu-Age products are thoroughly tested and manufactured under strict quality control with only first grade materials used. No responsibility however can be accepted for variations in the strength, colour, appearance, or workability brought about by on-site mixing procedures and curing conditions not within the control of Wattyl (NZ) Ltd or Nu-Age Plaster Ltd.

Issue of Manufacturer's Warranty (material only) by Wattyl (NZ) Ltd requires the submission of an Applicator's Warranty specifying:

- a) The Wattyl Granosite® coating system employed
- b) Wattyl Granosite® Products Used
- c) Project name and address
- d) Proof-of-sale invoices for materials used on the project
- e) The Builder/ Main contractor in conjunction with the Applicator signs and submits the approved Site Reference Area Acceptance form

And conditional upon:

- f) The system & products used are applied by a skilled Applicator in accordance with the Manufacturer's specifications and recommended methods of application.
- g) The substrate of the whole of the premises is substantially the same as the Site Reference Area.
- h) The product's components are stored in an approved manner and used within the recommended shelf life.

Note: Invoices for Wattyl Granosite® & Nu-Age materials, whether bought through Wattyl or outlets, must clearly state the date of purchase, products involved and all relevant batch numbers.

## MAINTENANCE SCHEDULE

System Type	Age	Procedure
All Granosite Nu-Age Cladding and Coating Systems	Annually	<p>Chemical / detergent wash. Have the entire coated area inspected by a person with sufficient experience to identify any maintenance requirements to ensure weathertightness. Undertake all necessary repairs immediately.</p> <p><b><i>For hard to remove stains, refer to the stain removal guide.</i></b></p>
Granosite Coating Systems	7 Years	<p>After seven years exposure the following maintenance procedure is required to validate the <i>Granosite Seven-Year Renewable Warranty</i>. Chemical / Detergent wash to remove all surface contaminates. Complete all necessary repairs. Ensure surface is clean, dry and free from surface contaminates and suitable for painting prior to the application of each coat.</p> <p>Apply one or two coats of the current finish coat as specified by Watty (NZ) Ltd.</p> <p>Application for the Warranty must be within 30 days of completion of the work and is subject to an inspection by a Watty Granosite representative, plus presentation by the <i>applicator</i> of the completed Quality Assurance checklist and materials documentation. After receipt of the applicators' warranty request upon completion of this treatment, a new <u>Manufacturer's Warranty</u> may be issued for a period of seven years.</p>
Granosite Nu-Age Cladding Systems	Annually	<p style="text-align: center;"><b><u>Nu-Therm 40/60 or Nu- Lite Owner's Maintenance Schedule</u></b></p> <p>Inspections of the complete cladding surface must be carried out at least annually at the end of summer. Because of settling after disturbances to the ground during construction, and the slow moisture-loss shrinkage of concrete slabs, it is recommended that six-monthly inspections be made for the first three years.</p> <p>A person with sufficient experience to identify any maintenance required should carry out the annual inspection for weathertightness.</p> <p>Any cracks or damaged areas, including flashings and seals that have deteriorated, must be repaired immediately to ensure the integrity of the building envelope is maintained.</p> <p>Any damage to the substrate must be repaired in accordance with the substrate manufacturer's instructions followed by re-plastering and recoating to the same standard as the original GranoTherm System installation.</p> <p>If chemical free framing timber has been used, it is imperative that the maintenance of the cladding system is followed rigorously to ensure the minimum moisture ingress takes place to prevent expensive and extensive structural repair work.</p>



### Residential Preventative Maintenance Schedule

		<p>Regular washing of the coating (at least once per year) is required to maintain the life and appearance of the weather-protective coating system. This should be carried out with a mild detergent and low-pressure water wash.</p> <p>As part of the Warranty conditions the finish coat(s) will need to be re-applied between years seven and eight as specified by WattyI (NZ) Ltd. For exposed locations washing and re-painting may be required more frequently.</p>
--	--	--

# Trade Centres

## AVONDALE TRADE CENTRE

2-14 Patiki Road  
AVONDALE  
Tel: (09) 820 6720  
Fax: (09) 820 6704

## NORTH SHORE TRADE CENTRE

235 Bush Road  
ALBANY  
Tel: (09) 415 3480 or (09) 415 3481  
Fax: (09) 415 3482

## EAST TAMAKI TRADE CENTRE

43 Greenmount Drive  
EAST TAMAKI  
Tel: (09) 274 0595 or (09) 274 5920  
Fax: (09) 273 8903

## NEWTON TRADE CENTRE

18 St Benedicts Street  
NEWTON  
Tel: (09) 302 7637  
Fax: (09) 302 7636

## ONEHUNGA TRADE CENTRE

10A Maurice Road  
ONEHUNGA  
Tel: (09) 571 2093  
Fax: (09) 571 2094

## MANUKAU TRADE CENTRE

15 Jack Conway Avenue  
MANUKAU CITY  
Tel: (09) 263 6848  
Fax: (09) 263 7353

## TAURANGA TRADE CENTRE

2 Glasgow Street  
TAURANGA  
Tel: (07) 571 2255 or (07) 571 2155  
Fax: (07) 571 2266

## HAMILTON TRADE CENTRE

8 Devon Street  
Frankton  
HAMILTON  
Tel: (07) 847 0440  
Fax: (07) 847 9954

## ROTORUA TRADE CENTRE

13 Waterford Street  
ROTORUA  
Tel: (07) 348 8960  
Fax: (07) 348 8153

## NEW PLYMOUTH TRADE CENTRE

301 Devon Street East  
NEW PLYMOUTH  
Tel: (06) 758 5888  
Fax: (06) 758 4222

## NAPIER TRADE CENTRE

47 Carlyle Street  
NAPIER  
Tel: (06) 835 2070  
Fax: (06) 835 6226

## LOWER HUTT TRADE CENTRE

2 Pretoria Street  
LOWER HUTT  
Tel: (04) 570 0436  
Fax: (04) 570 0438

## WELLINGTON TRADE CENTRE

1 Glover Street  
Ngauranga Gorge  
WELLINGTON  
Tel: (04) 471 0428  
Fax: (04) 471 0528

## TUAM STREET TRADE CENTRE

328 Tuam Street  
CHRISTCHURCH  
Tel: (03) 365 0963  
Fax: (03) 366 5462

## DUNEDIN TRADE CENTRE

Unit B, 239 Crawford Street  
DUNEDIN  
Tel: (03) 474 9981 or (03) 474 9983  
Fax: (03) 474 9982

